

4

## Parts List

ITEM	DESCRIPTION	PART NUMBER	QTY	NOTES
1	BOOT, ROUND, SHORT, MTP®, 3.6 mm	13466	1	
2	CRIMP BAND, ROUND, MTP®, 3.4 - 3.8 mm CABLES	16426	1	
3	SPRING PUSH, UNIVERSAL, 3.6 mm ROUND, MTP®	22823	1	
4	SPRING, UNIVERSAL, 20N	22515	1	
5	PIN CLAMP or PIN SPACER, MTP-16™	SEE KIT TABLE COLUMN A	1	NOTE 1
6	ASSEMBLY, HOUSING, MTP-16™	SEE KIT TABLE COLUMN B	1	
7	DUST CAP, MTP®	17242	1	

3



2

1

KIT P/N	KIT DESCRIPTION	PERFORMANCE	COLUMN A	COLUMN B	HSG ASSY COLOR
			PIN CLAMP/SPACER P/N	HSG ASSY P/N	
21187	KIT, MTP-16™, FEMALE, MM, 3.6 RND, SHORT BOOT, AQUA	MM or MM MTP Elite®	15391	16819	AQUA
21188	KIT, MTP-16™, MALE, MM, 3.6 RND, SHORT BOOT, AQUA	MM	17782	16819	AQUA
21189	KIT, MTP-16™, MALE, MM MTP Elite®, 3.6 RND, SHORT BOOT, AQUA	MM MTP Elite®	15609	16819	AQUA
21190	KIT, MTP-16™, FEMALE, MM, 3.6 RND, SHORT BOOT, MAGENTA	MM or MM MTP Elite®	15391	16822	MAGENTA
21191	KIT, MTP-16™, MALE, MM, 3.6 RND, SHORT BOOT, MAGENTA	MM	17782	16822	MAGENTA
21192	KIT, MTP-16™, MALE, MM MTP Elite®, 3.6 RND, SHORT BOOT, MAGENTA	MM MTP Elite®	15609	16822	MAGENTA
21193	KIT, MTP-16™, FEMALE, MM, 3.6 RND, SHORT BOOT, LIME	MM or MM MTP Elite®	15391	19103	LIME
21194	KIT, MTP-16™, MALE, MM, 3.6 RND, SHORT BOOT, LIME	MM	17782	19103	LIME
21195	KIT, MTP-16™, MALE, MM MTP Elite®, 3.6 RND, SHORT BOOT, LIME	MM MTP Elite®	15609	19103	LIME
21196	KIT, MTP-16™, FEMALE, SM, 3.6 RND, SHORT BOOT, GREEN	SM	15391	19068	GREEN
21197	KIT, MTP-16™, MALE, SM, 3.6 RND, SHORT BOOT, GREEN	SM	15609	19068	GREEN
21198	KIT, MTP-16™, FEMALE, SM MTP Elite®, 3.6 RND, SHORT BOOT, YELLOW	SM MTP Elite®	15391	19102	YELLOW
21199	KIT, MTP-16™, MALE, SM MTP Elite®, 3.6 RND, SHORT BOOT, YELLOW	SM MTP Elite®	18297	19102	YELLOW

**NOTES:**

1. MALE CONNECTOR KIT HAS PIN CLAMP ASSEMBLY.  
FEMALE CONNECTOR KIT HAS FEMALE PIN SPACER.

FERRULE / BOOT KIT SHOWN FOR REFERENCE ONLY,  
MUST BE PURCHASED SEPARATELY

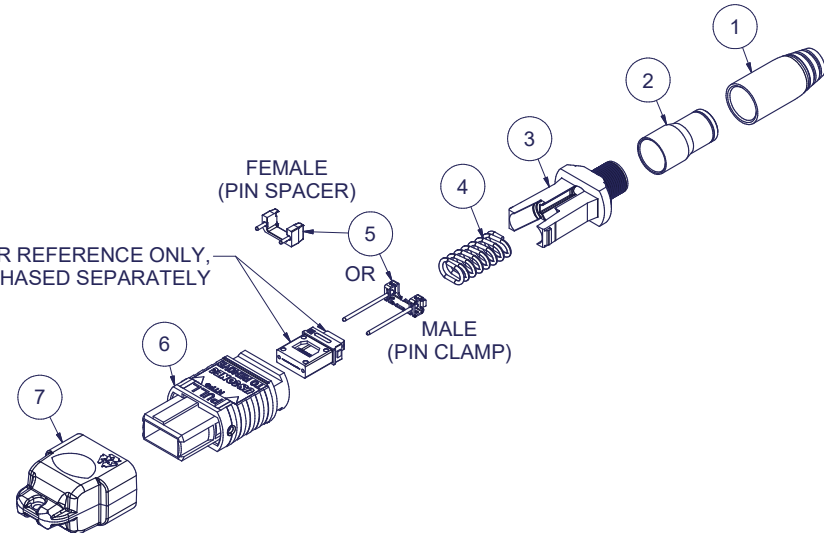

▲ DENOTES CRITICAL DIMENSION

USCONEC LTD. PROPRIETARY  
THIS DOCUMENT AND THE ASSOCIATED DATA CONTAIN RESTRICTED  
INFORMATION THAT IS USCONEC LTD. PROPERTY. DISCLOSE OR DUPLICATE FOR  
OTHERS ONLY AS AUTHORIZED BY USCONEC LTD.

**Material:**

REV	DATE	DESCRIPTION	ECN
X1	4/10/19	-	2214-mm
A	6/26/19	INITIAL RELEASE	
B	11/1/21	SPRING 22515 was 17698; SPRING PUSH 22823 was 19738; ADD'D SME KIT P/N'S 21198 & 21199; UPDATED DWG TITLE & KIT DESCRIPTIONS	2420-mm

**CUSTOMER DRAWING**

DIMENSIONS FOR REFERENCE ONLY

THIRD ANGLE PROJECTION

**METRIC/mm****USCONEC**

Hickory, NC  
800-769-0944  
www.usconec.com

TITLE  
KIT, MTP-16™ CONNECTOR,  
3.4 - 3.8 mm RND, SHORT BOOT

SIZE	S&M Part No.:	DWG NO.	REV
B	SEE TABLE	<b>C21187</b>	B
SCALE	Drafter	Date:	SHEET
N.T.S.	M.McCroskey	4/10/2019	1 OF 2

4

3



2

1

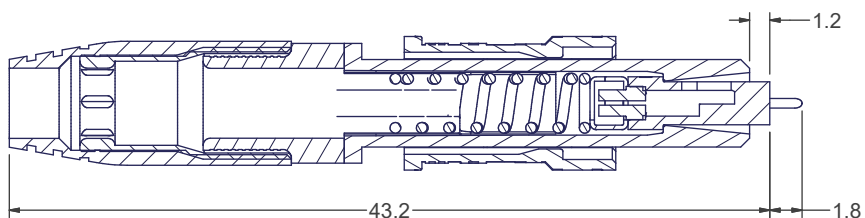
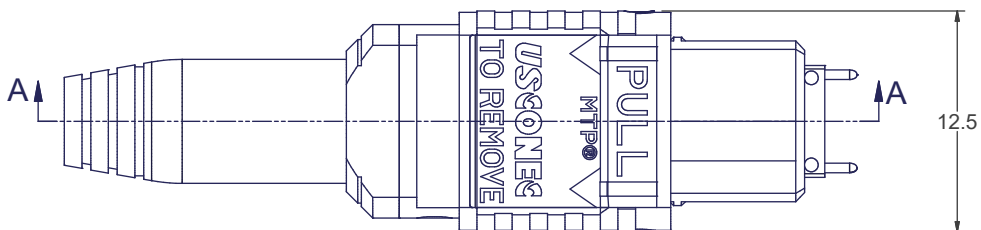
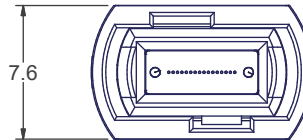
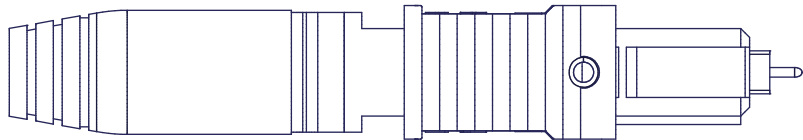

SECTION A-A

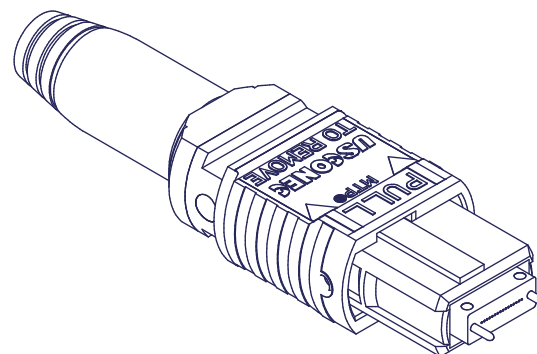

▲ DENOTES CRITICAL DIMENSION

**USCONEC LTD. PROPRIETARY**  
 THIS DOCUMENT AND THE ASSOCIATED DATA CONTAIN RESTRICTED INFORMATION THAT IS USCONEC LTD. PROPERTY. DISCLOSE OR DUPLICATE FOR OTHERS ONLY AS AUTHORIZED BY USCONEC LTD.

**Material:**

REV.	DATE	DESCRIPTION	ECN

**CUSTOMER DRAWING**



Hickory, NC  
 800-769-0944  
 www.usconec.com

DIMENSIONS FOR REFERENCE ONLY

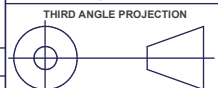

**TITLE**  
 KIT, MTP-16™ CONNECTOR,  
 3.4 - 3.8 mm RND, SHORT BOOT

SIZE <b>A3</b>	S&M Part No.: SEE TABLE	DWG NO. <b>C21187</b>	REV B
SCALE N.T.S.	Drafter M. McCroskey	Date: 4/10/2019	SHEET 2 OF 2

**METRIC/mm**