

| 4 | | | | | 3 | | | 2 | | 1 | | |
|------------|---|------------------------|-----|--------|---------|--|---------------------|----------------------|--------------|----------------|--|--|
| Parts List | | | | | KIT P/N | KIT DESCRIPTION | PERFORMANCE | COLUMN A | | COLUMN B | | |
| ITEM | DESCRIPTION | PART NUMBER | QTY | NOTES | | | | PIN CLAMP/SPACER P/N | HSG ASSY P/N | HSG ASSY COLOR | | |
| 1 | SPRING PUSH, UNIVERSAL, OVAL & RIBBON, MTP® | 13822 | 1 | | 21040 | KIT, MTP-16™, FEMALE, MM, SHORT, RIBBON, HSF, AQUA | MM or MM MTP Elite® | 15391 | 16819 | AQUA | | |
| | | | | | 21041 | KIT, MTP-16™, MALE, MM, SHORT, RIBBON, HSF, AQUA | MM | 17782 | 16819 | AQUA | | |
| | | | | | 21042 | KIT, MTP-16™, MALE, MM MTP Elite®, SHORT, RIBBON, HSF, AQUA | MM MTP Elite® | 15609 | 16819 | AQUA | | |
| 2 | SPRING, UNIVERSAL, 20N | 17698 | 1 | | 21043 | KIT, MTP-16™, FEMALE, MM, SHORT, RIBBON, HSF, MAGENTA | MM or MM MTP Elite® | 15391 | 16822 | MAGENTA | | |
| | | | | | 21044 | KIT, MTP-16™, MALE, MM, SHORT, RIBBON, HSF, MAGENTA | MM | 17782 | 16822 | MAGENTA | | |
| | | | | | 21045 | KIT, MTP-16™, MALE, MM MTP Elite®, SHORT, RIBBON, HSF, MAGENTA | MM MTP Elite® | 15609 | 16822 | MAGENTA | | |
| 3 | PIN CLAMP or PIN SPACER | SEE KIT TABLE COLUMN A | 1 | NOTE 1 | 21046 | KIT, MTP-16™, FEMALE, MM, SHORT, RIBBON, HSF, LIME | MM or MM MTP Elite® | 15391 | 19103 | LIME | | |
| | | | | | 21047 | KIT, MTP-16™, MALE, MM, SHORT, RIBBON, HSF, LIME | MM | 17782 | 19103 | LIME | | |
| 4 | ASSEMBLY, HOUSING, MTP-16™ | SEE KIT TABLE COLUMN B | 1 | | 21048 | KIT, MTP-16™, MALE, MM MTP Elite®, SHORT, RIBBON, HSF, LIME | MM MTP Elite® | 15609 | 19103 | LIME | | |
| | | | | | 21049 | KIT, MTP-16™, FEMALE, SM, SHORT, RIBBON, HSF, GREEN | SM | 15391 | 19068 | GREEN | | |
| 5 | DUST CAP, MTP® | 17242 | 1 | | 21050 | KIT, MTP-16™, MALE, SM, SHORT, RIBBON, HSF, GREEN | SM | 15609 | 19068 | GREEN | | |

NOTES:

1. MALE CONNECTOR KIT HAS PIN CLAMP ASSEMBLY.
FEMALE CONNECTOR KIT HAS FEMALE PIN SPACER.

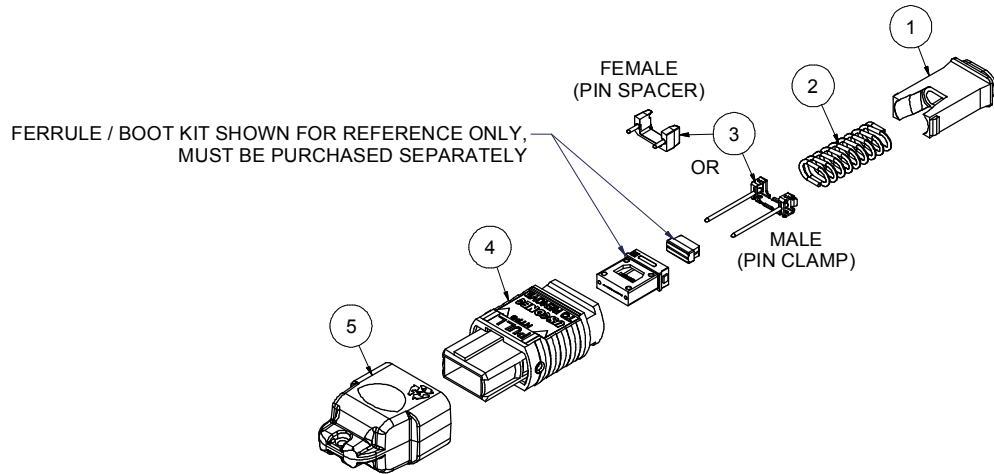

USCONEC LTD. PROPRIETARY
THIS DOCUMENT AND THE ASSOCIATED DATA CONTAIN RESTRICTED INFORMATION THAT IS USCONEC LTD. PROPERTY. DISCLOSE OR DUPLICATE FOR OTHERS ONLY AS AUTHORIZED BY USCONEC LTD.

Material:

| REV | DATE | DESCRIPTION | ECN |
|-----|---------|-----------------|---------|
| X1 | 6/13/19 | --- | 2222-mm |
| A | 7/2/19 | INITIAL RELEASE | |

CUSTOMER DRAWING

DIMENSIONS FOR REFERENCE ONLY

THIRD ANGLE PROJECTION

METRIC/mm

▲ DENOTES CRITICAL DIMENSION

USCONEC Hickory, NC
800-769-0944
www.usconec.com

TITLE
KIT, MTP-16™ CONNECTOR, SHORT, RIBBON, HIGH SPRING FORCE

| | | | |
|----------|---------------|---------------|----------|
| SIZE | S&M Part No.: | DWG NO. | REV |
| B | SEE TABLE | C21040 | A |
| SCALE | Drafter | Date: | |
| N.T.S. | M.McCROSKEY | 6/13/2019 | |

SHEET 1 OF 2

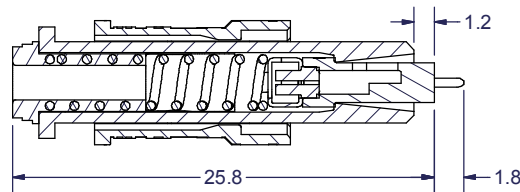
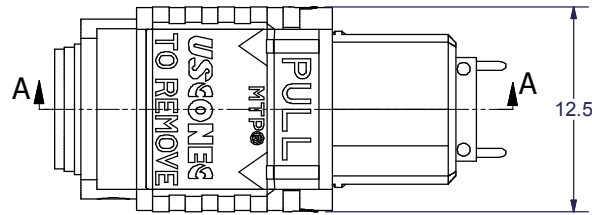
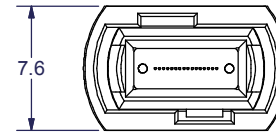
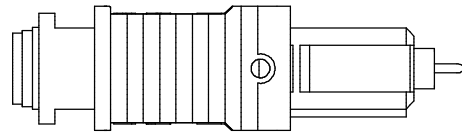

SECTION A-A

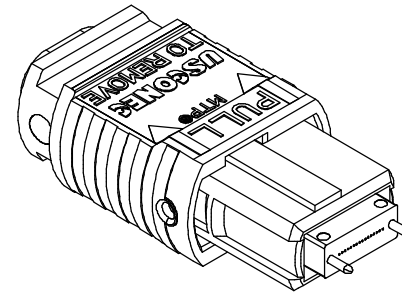

▲ DENOTES CRITICAL DIMENSION

| <p align="center">USCONEC LTD. PROPRIETARY THIS DOCUMENT AND THE ASSOCIATED DATA CONTAIN RESTRICTED INFORMATION THAT IS USCONEC LTD. PROPERTY. DISCLOSE OR DUPLICATE FOR OTHERS ONLY AS AUTHORIZED BY USCONEC LTD.</p> | | | | <p align="center">CUSTOMER DRAWING</p> | | | | <p align="right">Hickory, NC 800-769-0944 www.usconec.com</p> | | | | | | | | | | | | | | | | | | | | | |
|---|------|-------------|-----|---|------|------------------------------|-----|--|--|--|--|--|--|--|--|--|--|--|--|--|--|--|--|--|--|--|--|----------------------------------|--|
| <p>Material:</p> <table border="1"> <thead> <tr> <th>REV</th> <th>DATE</th> <th>DESCRIPTION</th> <th>ECN</th> </tr> </thead> <tbody> <tr><td> </td><td> </td><td> </td><td> </td></tr> <tr><td> </td><td> </td><td> </td><td> </td></tr> <tr><td> </td><td> </td><td> </td><td> </td></tr> <tr><td> </td><td> </td><td> </td><td> </td></tr> </tbody> </table> | | | | REV | DATE | DESCRIPTION | ECN | | | | | | | | | | | | | | | | | <p>▲ DIMENSIONS FOR REFERENCE ONLY</p> <p>THIRD ANGLE PROJECTION</p> | | <p>TITLE KIT, MTP-16™ CONNECTOR, SHORT, RIBBON, HIGH SPRING FORCE</p> | | <p>SCALE: B SEE TABLE</p> | |
| REV | DATE | DESCRIPTION | ECN | | | | | | | | | | | | | | | | | | | | | | | | | | |
| | | | | | | | | | | | | | | | | | | | | | | | | | | | | | |
| | | | | | | | | | | | | | | | | | | | | | | | | | | | | | |
| | | | | | | | | | | | | | | | | | | | | | | | | | | | | | |
| | | | | | | | | | | | | | | | | | | | | | | | | | | | | | |
| <p>SCALE: N.T.S.</p> | | | | <p>Drafter: M. McCROSKEY</p> | | <p>DWG NO: C21040</p> | | <p>Date: 6/13/2019</p> | | | | | | | | | | | | | | | | | | | | | |
| <p>SCALE: N.T.S.</p> | | | | <p>SHEET 2 OF 2</p> | | <p>REV A</p> | | <p>SHEET 2 OF 2</p> | | | | | | | | | | | | | | | | | | | | | |