

4				
Parts List				
ITEM	DESCRIPTION	PART NUMBER	QTY	NOTES
1	SPRING PUSH, UNIVERSAL, OVAL & RIBBON, MTP®	13822	1	
2	SPRING, UNIVERSAL, 20N	17698	1	
3	PIN CLAMP or PIN SPACER	SEE KIT TABLE COLUMN A	1	NOTE 1
4	HOUSING ASSY, MTP® PRO	SEE KIT TABLE COLUMN B	1	
5	DUST CAP	17242	1	

3			2		1		
KIT P/N	KIT DESCRIPTION	PERFORMANCE	COLUMN A PIN CLAMP/SPACER P/N	COLUMN B HSG ASSY P/N	HSG COLOR		
21032	KIT, MTP® PRO, FEMALE, MM MTP Elite®, SHORT, RIBBON, HSF, AQUA	MM MTP Elite®	17861	18189	AQUA		
21033	KIT, MTP® PRO, MALE, MM MTP Elite®, SHORT, RIBBON, HSF, AQUA	MM MTP Elite®	19038	18189	AQUA		
21034	KIT, MTP® PRO, FEMALE, MM MTP Elite®, SHORT, RIBBON, HSF, HEATHER VIOLET	MM MTP Elite®	17861	18191	HEATHER VIOLET		
21035	KIT, MTP® PRO, MALE, MM MTP Elite®, SHORT, RIBBON, HSF, HEATHER VIOLET	MM MTP Elite®	19038	18191	HEATHER VIOLET		
21036	KIT, MTP® PRO, FEMALE, MM MTP Elite®, SHORT, RIBBON, HSF, LIME	MM MTP Elite®	17861	19486	LIME		
21037	KIT, MTP® PRO, MALE, MM MTP Elite®, SHORT, RIBBON, HSF, LIME	MM MTP Elite®	19038	19486	LIME		
21038	KIT, MTP® PRO, FEMALE, SM MTP Elite®, SHORT, RIBBON, HSF, GREEN	SM MTP Elite®	17861	18190	GREEN		
21039	KIT, MTP® PRO, MALE, SM MTP Elite®, SHORT, RIBBON, HSF, GREEN	SM MTP Elite®	19039	18190	GREEN		

NOTES:
1. MALE CONNECTOR KIT HAS PIN CLAMP ASSEMBLY, FEMALE CONNECTOR KIT HAS FEMALE PIN SPACER

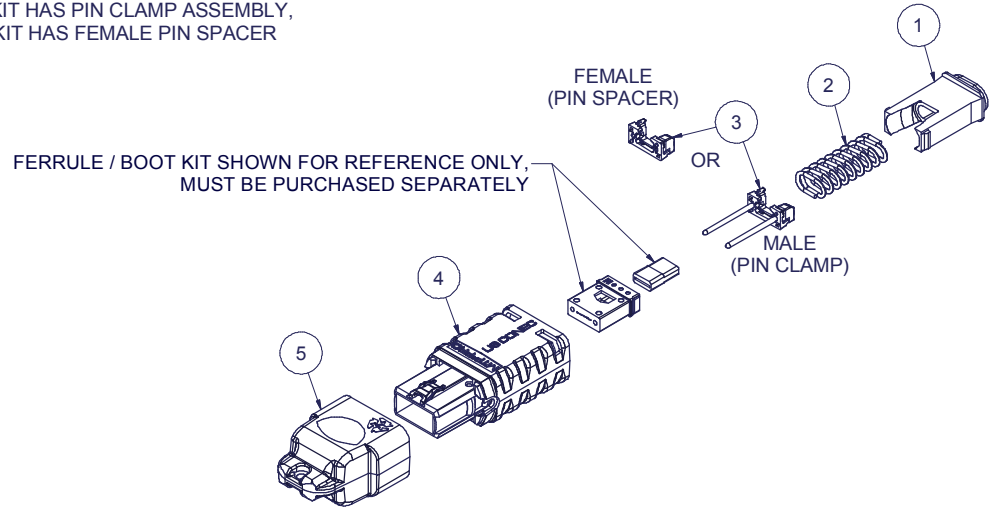

USCONEC LTD. PROPRIETARY
THIS DOCUMENT AND THE ASSOCIATED DATA CONTAIN RESTRICTED INFORMATION THAT IS USCONEC LTD. PROPERTY. DISCLOSE OR DUPLICATE FOR OTHERS ONLY AS AUTHORIZED BY USCONEC LTD.

Material:

REV	DATE	DESCRIPTION	ECN
X1	5/8/19		
X2	5/8/19	CORRECTED THE PERFORMANCE FOR P/N'S 21036 & 21037; ADDED KIT P/N'S 21038 & 21039	2031-mm
A	6/26/19	INITIAL RELEASE	

CUSTOMER DRAWING

DIMENSIONS FOR REFERENCE ONLY

THIRD ANGLE PROJECTION

METRIC/mm

▲ DENOTES CRITICAL DIMENSION

USCONEC Hickory, NC
800-769-0944
www.usconec.com

TITLE
KIT, MTP® PRO CONNECTOR, SHORT, RIBBON, HIGH SPRING FORCE

SIZE	S&M Part No.:	DWG NO	REV
B	SEE TABLE	C21032	A
SCALE	Drafter	Date:	SHEET
N.T.S.	M.McCROSKEY	5/8/2019	1 OF 2

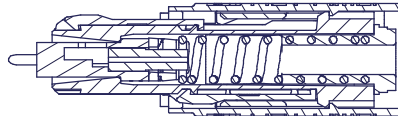
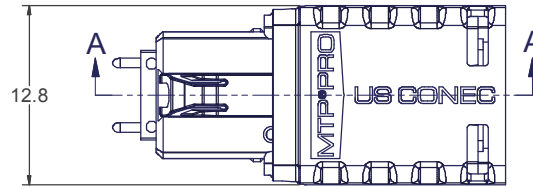
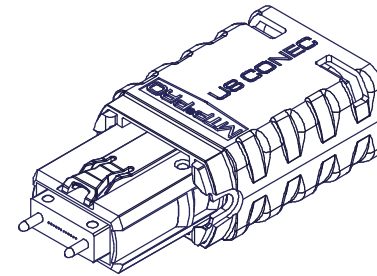
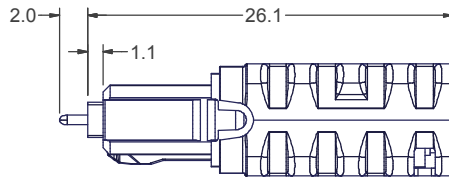
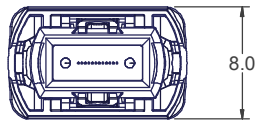

SECTION A-A

USCONEC LTD. PROPRIETARY
 THIS DOCUMENT AND THE ASSOCIATED DATA CONTAIN RESTRICTED
 INFORMATION THAT IS USCONEC LTD. PROPERTY. DISCLOSE OR DUPLICATE FOR
 OTHERS ONLY AS AUTHORIZED BY USCONEC LTD.

Material:

REV	DATE	DESCRIPTION	ECN
		SEE SHEET 1	

CUSTOMER
DRAWING

DIMENSIONS FOR REFERENCE
ONLY

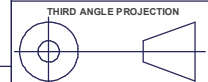

METRIC/mm



▲ DENOTES CRITICAL DIMENSION

Hickory, NC
 800-769-0944
www.usconec.com

TITLE
 KIT, MTP® PRO CONNECTOR, SHORT,
 RIBBON, HIGH SPRING FORCE

SIZE	S&M Part No.:	DWG NO	REV
B	SEE SHEET 1	C21032	A
SCALE	Drafter	Date:	SHEET
N.T.S.	M. McCROSKEY	5/8/2019	2 OF 2