

4

3

2

1

Parts List

ITEM	DESCRIPTION	PART NUMBER	QTY	NOTES
1	BOOT, RIBBON, UNIVERSAL, MTP®	19676	1	
2	SPRING PUSH, UNIVERSAL, OVAL & RIBBON, MTP®	5551	1	
3	SPRING, UNIVERSAL, 9.8N	17167	1	
4	PIN CLAMP, MTP® PRO	SEE KIT TABLE COLUMN A	1	NOTE 1
5	HOUSING ASSY, MTP® PRO	SEE KIT TABLE COLUMN B	1	
6	DUST CAP	17242	1	

KIT P/N	KIT DESCRIPTION	PERFORMANCE	COLUMN A PIN CLAMP P/N	COLUMN B HSG ASSY P/N	HSG COLOR
18706	KIT, MTP® PRO, FEMALE, MM MTP Elite®, RIBBON, AQUA HSG	MM MTP Elite®	25084	18189	AQUA
18707	KIT, MTP® PRO, MALE, MM MTP Elite®, RIBBON, AQUA HSG	MM MTP Elite®	25085	18189	AQUA
18708	KIT, MTP® PRO, FEMALE, MM MTP Elite®, RIBBON, HEATHER VIOLET HSG	MM MTP Elite®	25084	18191	HEATHER VIOLET
18709	KIT, MTP® PRO, MALE, MM MTP Elite®, RIBBON, HEATHER VIOLET HSG	MM MTP Elite®	25085	18191	HEATHER VIOLET
18710	KIT, MTP® PRO, FEMALE, SM MTP Elite®, RIBBON, GREEN HSG	SM MTP Elite®	25084	18190	GREEN
18711	KIT, MTP® PRO, MALE, SM MTP Elite®, RIBBON, GREEN HSG	SM MTP Elite®	25087	18190	GREEN
21020	KIT, MTP® PRO, FEMALE, MM MTP Elite®, RIBBON, LIME HSG	MM MTP Elite®	25084	19486	LIME
21021	KIT, MTP® PRO, MALE, MM MTP Elite®, RIBBON, LIME HSG	MM MTP Elite®	25085	19486	LIME

NOTES:

1. MALE CONNECTOR KIT HAS MALE PIN CLAMP ASSEMBLY, FEMALE CONNECTOR KIT HAS FEMALE PIN CLAMP ASSEMBLY.

FERRULE / BOOT KIT SHOWN FOR REFERENCE ONLY, MUST BE PURCHASED SEPARATELY

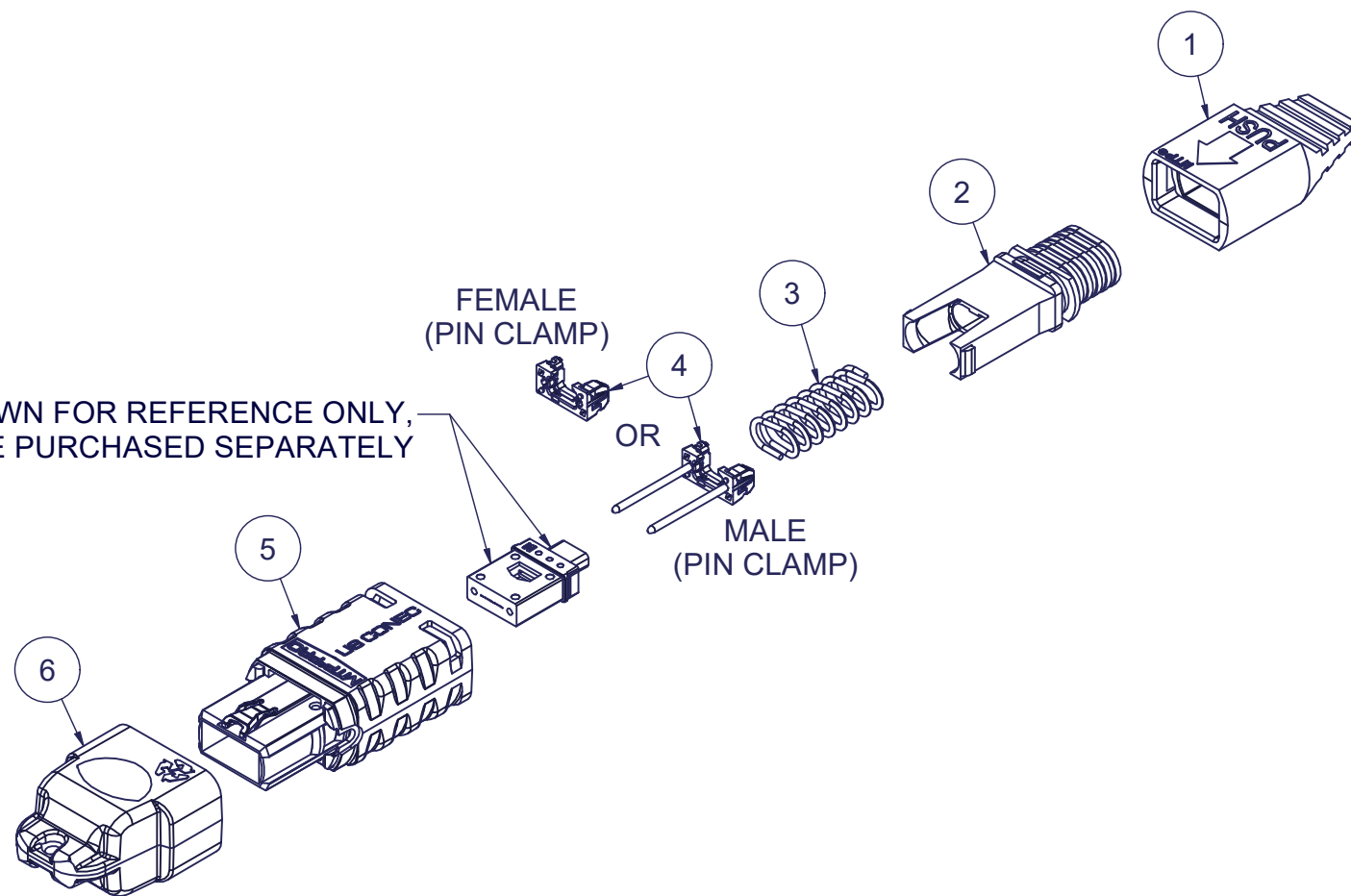

▲ DENOTES CRITICAL DIMENSION

USCONEC LTD. PROPRIETARY  
THIS DOCUMENT AND THE ASSOCIATED DATA CONTAIN RESTRICTED INFORMATION THAT IS USCONEC LTD. PROPERTY. DISCLOSE OR DUPLICATE FOR OTHERS ONLY AS AUTHORIZED BY USCONEC LTD.

CUSTOMER DRAWING

USCONEC  
Hickory, NC  
800-769-0944  
www.usconec.com

Material:

REV.	DATE	DESCRIPTION	ECN
A	3/11/19	INITIAL RELEASE	2200-mm
B1	4/9/19	BOM CHG'S: REM'D P/N 17644; ADD'D P/N'S 5551 & 19676; ADD'D LIME KIT P/N'S 21020 & 21021; KIT LENGTH CHG: 32.8 was 34.1	2210-mm
B	4/17/19	RELEASE	
C	7/17/19	CORRECTED ASSY & ASSY LENGTH ON SHEET 2	2753-mm
D	4/14/25	PIN CLAMP CHGS: 25084 was 17861, 25085 was 19038, 25087 was 19039	

DIMENSIONS FOR REFERENCE ONLY

THIRD ANGLE PROJECTION

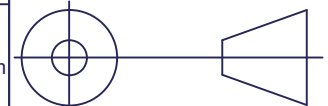

METRIC/mm

TITLE  
KIT, MTP® PRO CONNECTOR, RIBBON

SIZE B	S&M Part No.: SEE TABLE	DWG NO. C18706	REV D
SCALE N.T.S.	Drafter M.McCROSKEY	Date: 6/27/2017	SHEET 1 OF 2

4

3

2

1

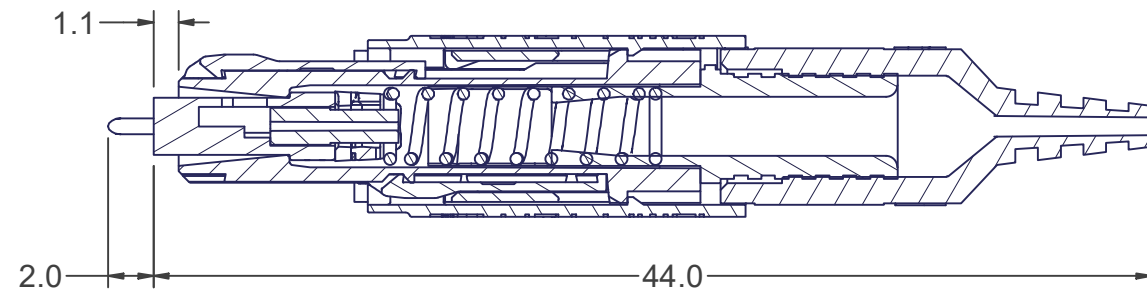
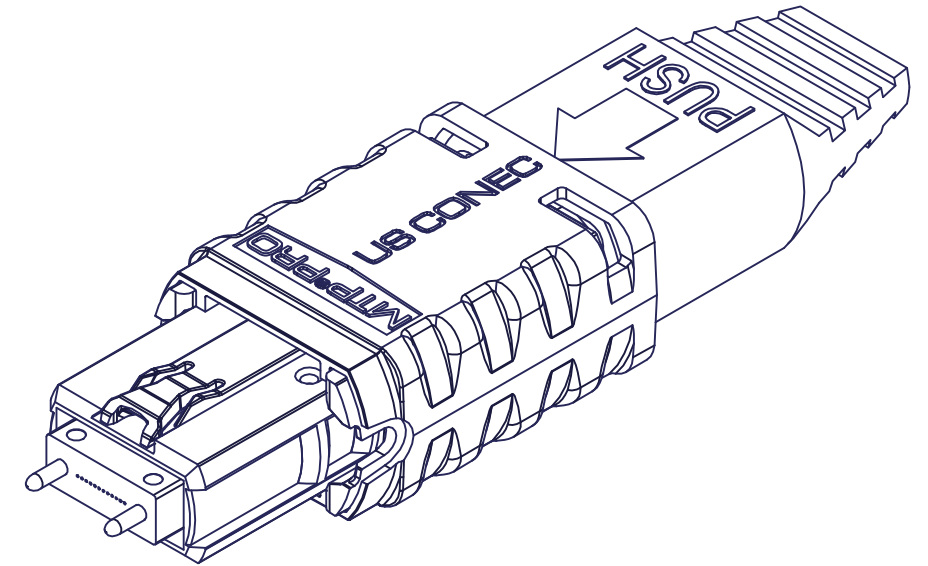
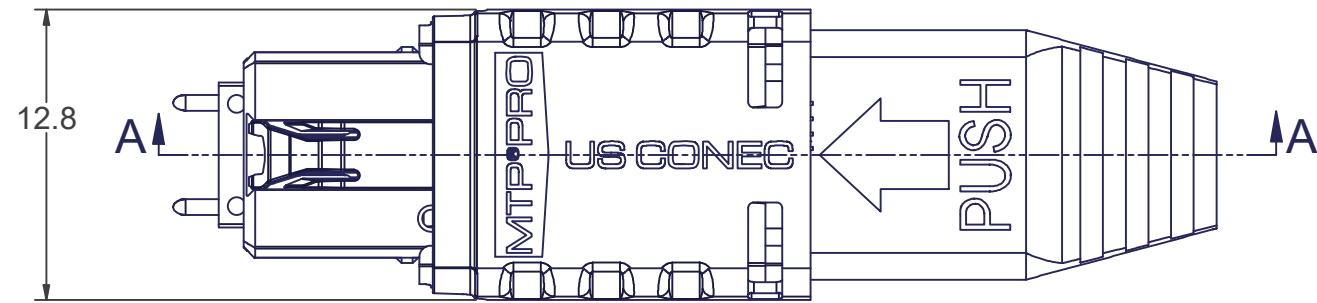
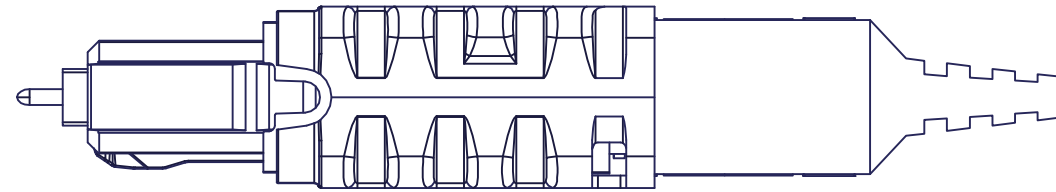
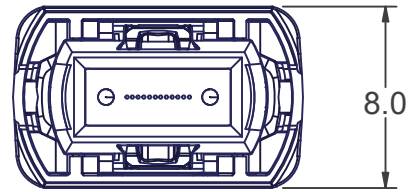

SECTION A-A

▲ DENOTES CRITICAL DIMENSION

**USCONEC LTD. PROPRIETARY**  
 THIS DOCUMENT AND THE ASSOCIATED DATA CONTAIN RESTRICTED INFORMATION THAT IS USCONEC LTD. PROPERTY. DISCLOSE OR DUPLICATE FOR OTHERS ONLY AS AUTHORIZED BY USCONEC LTD.

**Material:**

REV.	DATE	DESCRIPTION	ECN
		SEE SHEET 1	

**CUSTOMER DRAWING**

DIMENSIONS FOR REFERENCE ONLY

THIRD ANGLE PROJECTION

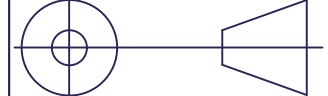

**METRIC/mm**

**USCONEC** Hickory, NC  
 800-769-0944  
 www.usconec.com

**TITLE**  
 KIT, MTP® PRO CONNECTOR, RIBBON

SIZE <b>B</b>	S&M Part No.: SEE SHEET 1	DWG NO. <b>C18706</b>	REV D
SCALE N.T.S.	Drafter M.McCROSKEY	Date: 6/27/2017	SHEET 2 OF 2