

4

3

2

1

Parts List

ITEM	DESCRIPTION	PART NUMBER	QTY	NOTES
1	BOOT, ROUND, 4.5 mm CABLE	13168	1	
2	CRIMP BAND, 4.0, ROUND, MTP® & MXC®	16543	1	
3	SPRING PUSH, UNIVERSAL, 2 PC, ANGLED	19973	1	
4	SPRING, UNIVERSAL, 20N	17698	1	
5	PIN CLAMP, MTP® PRO	SEE KIT TABLE COLUMN A	1	NOTE 1
6	HOUSING ASSY, MTP® PRO	SEE KIT TABLE COLUMN B	1	
7	DUST CAP, MTP®	17242	1	

KIT P/N	KIT DESCRIPTION	PERFORMANCE	COLUMN A PIN CLAMP P/N	COLUMN B HSG ASSY P/N	HSG COLOR
18628	KIT, MTP® PRO, FEMALE, MM MTP Elite®, 4.0 RND, ANGLED SPRING PUSH, HSF, AQUA	MM MTP Elite®	17861	18189	AQUA
18629	KIT, MTP® PRO, MALE, MM MTP Elite®, 4.0 RND, ANGLED SPRING PUSH, HSF, AQUA	MM MTP Elite®	19038	18189	AQUA
18630	KIT, MTP® PRO, FEMALE, MM MTP Elite®, 4.0 RND, ANGLED SPRING PUSH, HSF, HEATHER VIOLET	MM MTP Elite®	17861	18191	HEATHER VIOLET
18631	KIT, MTP® PRO, MALE, MM MTP Elite®, 4.0 RND, ANGLED SPRING PUSH, HSF, HEATHER VIOLET	MM MTP Elite®	19038	18191	HEATHER VIOLET
18632	KIT, MTP® PRO, FEMALE, SM MTP Elite®, 4.0 RND, ANGLED SPRING PUSH, HSF, GREEN	SM MTP Elite®	17861	18190	GREEN
18633	KIT, MTP® PRO, MALE, SM MTP Elite®, 4.0 RND, ANGLED SPRING PUSH, HSF, GREEN	SM MTP Elite®	19039	18190	GREEN
20972	KIT, MTP® PRO, FEMALE, MM MTP Elite®, 4.0 RND, ANGLED SPRING PUSH, HSF, LIME	MM MTP Elite®	17861	19486	LIME
20973	KIT, MTP® PRO, MALE, MM MTP Elite®, 4.0 RND, ANGLED SPRING PUSH, HSF, LIME	MM MTP Elite®	19038	19486	LIME

NOTES:

1. MALE CONNECTOR KIT HAS MALE PIN CLAMP ASSEMBLY,
FEMALE CONNECTOR KIT HAS FEMALE PIN CLAMP ASSEMBLY

FERRULE / BOOT KIT SHOWN FOR REFERENCE ONLY,
MUST BE PURCHASED SEPARATELY

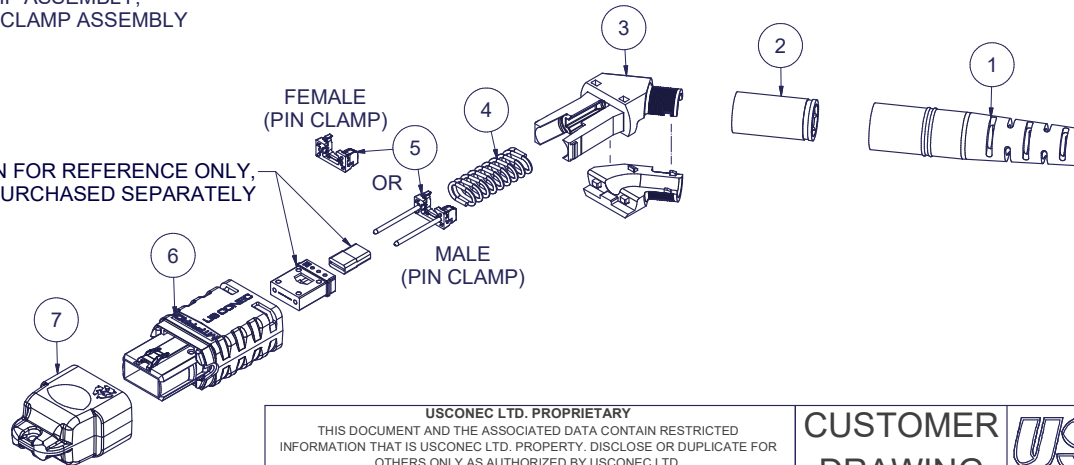

▲ DENOTES CRITICAL DIMENSION

USCONEC LTD. PROPRIETARY			
THIS DOCUMENT AND THE ASSOCIATED DATA CONTAIN RESTRICTED INFORMATION THAT IS USCONEC LTD. PROPERTY. DISCLOSE OR DUPLICATE FOR OTHERS ONLY AS AUTHORIZED BY USCONEC LTD.			
Material:			
REV	DATE	DESCRIPTION	ECN
X1	5/9/18	-	
A	5/20/20	ADD'D LIME KIT P/N'S 20972 & 20973; ADD'D VIEW W/ ADAPTER ON SHT 2	2089-mm
		INITIAL RELEASE	

CUSTOMER DRAWING

DIMENSIONS FOR REFERENCE ONLY

THIRD ANGLE PROJECTION

METRIC/mm

USCONEC

Hickory, NC
800-769-0944
www.usconec.com

TITLE
KIT, MTP® PRO CONN., 3.8 - 4.2 mm RND CBL,
ANGLED SPRING PUSH, HIGH SPRING FORCE

SIZE	S&M Part No.:	DWG NO.	REV
B	SEE TABLE	C18628	A
SCALE	Drafter	Date:	
N.T.S.	M.McCROSKEY	5/9/2018	

SHEET 1 OF 2

4

3

2

1

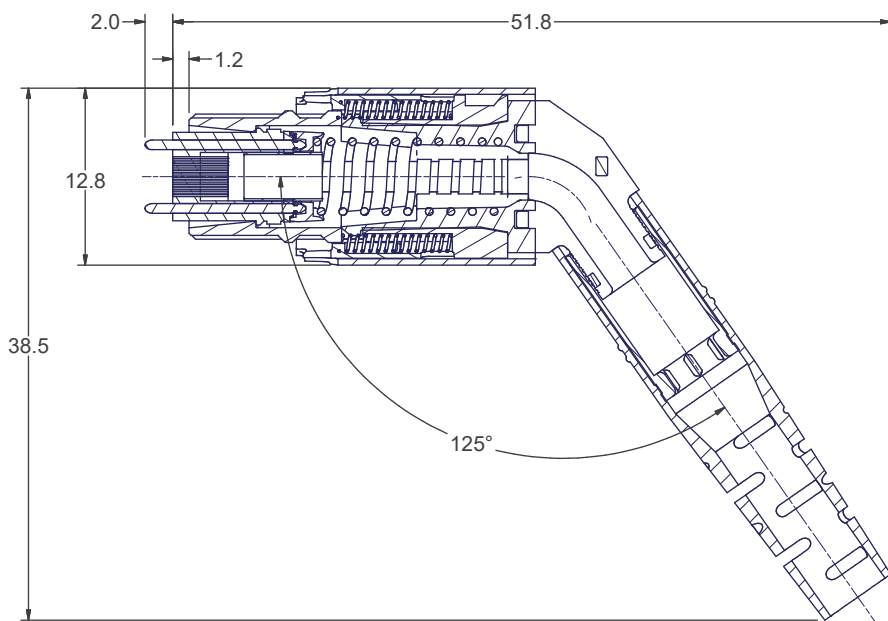

SECTION A-A

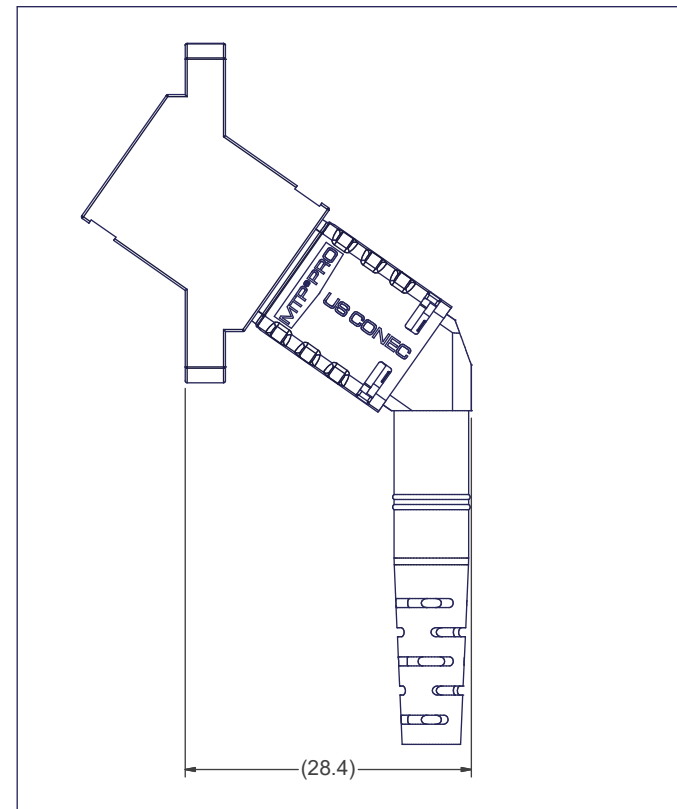
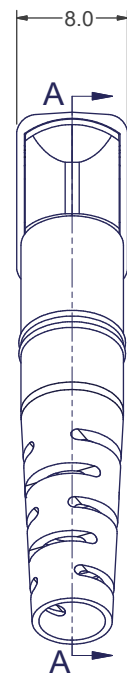

MTP® PRO CONNECTOR SHOWN WITH ANGLED MTP® ADAPTER (ANGLED MTP® ADAPTER SOLD SEPARATELY)

▲ DENOTES CRITICAL DIMENSION

USCONEC LTD. PROPRIETARY
THIS DOCUMENT AND THE ASSOCIATED DATA CONTAIN RESTRICTED INFORMATION THAT IS USCONEC LTD. PROPERTY. DISCLOSE OR DUPLICATE FOR OTHERS ONLY AS AUTHORIZED BY USCONEC LTD.

Material:

REV.	DATE	DESCRIPTION	ECN

CUSTOMER DRAWING



Hickory, NC
800-769-0944
www.usconec.com

DIMENSIONS FOR REFERENCE ONLY

TITLE
KIT, MTP® PRO CONN., 3.8 - 4.2 mm RND CBL, ANGLED SPRING PUSH, HIGH SPRING FORCE

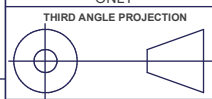

SIZE A3	S&M Part No.: SEE TABLE	DWG NO. C18628	REV A
-------------------	----------------------------	--------------------------	----------

METRIC/mm

SCALE N.T.S.	Drafter M.McCROSKY	Date: 5/9/2018	SHEET 2 OF 2
-----------------	-----------------------	-------------------	--------------