

Part Number	AR Coating Wavelength	Performance Specification
17813	Uncoated	N/A
18844	850nm AR Coating On Optical Window	<= 0.5% reflection
18977	1310nm AR Coating On Optical Window	

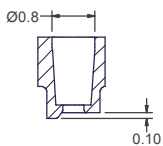

SECTION B-B

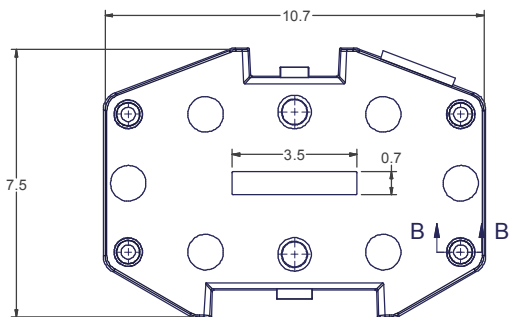
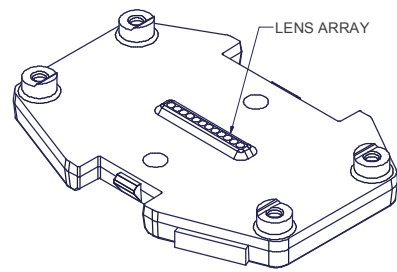
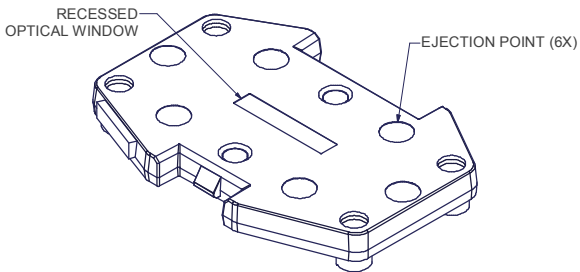
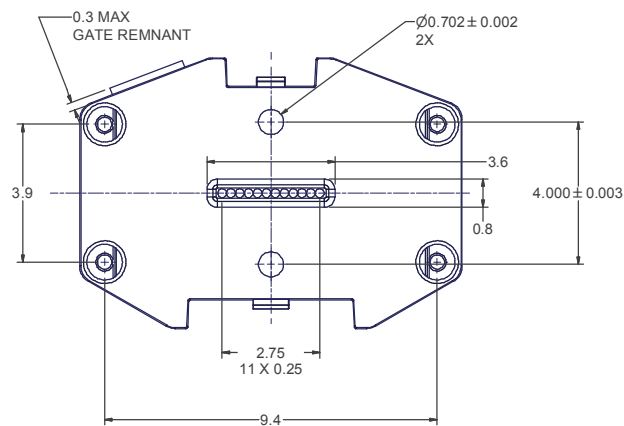
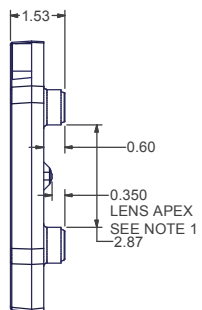

NOTES

1. LENSES ARE OPTIMIZED FOR VCSEL/PD ARRAY OF 150um HEIGHT LEAVING 200um BETWEEN LENS APEX AND ACTIVE DEVICES

▲ DENOTES CRITICAL DIMENSION

<p>USCONEC LTD. PROPRIETARY THIS DOCUMENT AND THE ASSOCIATED DATA CONTAIN RESTRICTED INFORMATION THAT IS USCONEC LTD. PROPERTY. DISCLOSE OR DUPLICATE FOR OTHERS ONLY AS AUTHORIZED BY USCONEC LTD.</p>			<p>CUSTOMER DRAWING</p>		<p>USCONEC Hickory, NC 800-769-0944 www.usconec.com</p>	
<p>Material: MAT'L SPEC# C16653</p>			<p>TITLE MECHANICAL OPTICAL INTERFACE, 25+Gbps</p>		<p>SCALE: SEE TABLE DWG NO: C17813</p>	
REV	DATE	DESCRIPTION	ECN	<p>THIRD ANGLE PROJECTION</p>		REV
X2	8/24/16	INCREASED FROM 4 TO 6 EJECTOR LOCATIONS		<p>SIZE: SEE TABLE</p>		B
X3	12/13/16	ADDED DRAFT TO VERTICAL SURFACES		<p>DRAWN: D. KURTZ</p>		
A	3/17/17	ADD'D TO DWG: TABLE, P/N 18844 & MAT'L SPEC INFO; REVISED TITLE: ADD'D 25+ Gbps TO TITLE	2013-mm	<p>DATE: 6/9/2016</p>		
B1	5/22/17	ADDED P/N 18977 TO CHART	2067-bt	<p>SHEET 1 OF 1</p>		
B	6/1/17	RELEASE	2067-bt			