

| P/N   | DESCRIPTION       |
|-------|-------------------|
| 17340 | BOOT 900 μm WHITE |
| 17341 | BOOT 900 μm BLACK |
| 17342 | BOOT 900 μm AQUA  |
| 17343 | BOOT 900 μm GREEN |
| 17344 | BOOT 900 μm BLUE  |

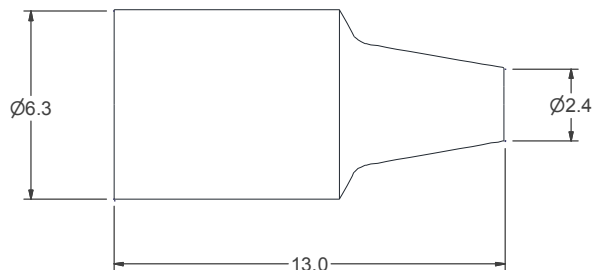

USCONEC LTD. PROPRIETARY  
 THIS DOCUMENT AND THE ASSOCIATED DATA CONTAIN RESTRICTED  
 INFORMATION THAT IS USCONEC LTD. PROPERTY. DISCLOSE OR DUPLICATE FOR  
 OTHERS ONLY AS AUTHORIZED BY USCONEC LTD.

**Material:**

| REV | DATE    | DESCRIPTION     | ECN     |
|-----|---------|-----------------|---------|
| X1  | 3/29/16 | -               | 1908-bt |
| A   | 4/12/16 | INITIAL RELEASE | 1908-bt |
|     |         |                 |         |
|     |         |                 |         |

**CUSTOMER  
DRAWING**

DIMENSIONS FOR REFERENCE  
ONLY

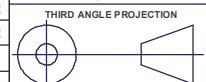

**METRIC/mm**



Hickory, NC  
 800-769-0944  
[www.usconec.com](http://www.usconec.com)

TITLE  
**BOOT, 900 μm, SC**

|                  |                                   |                           |                            |
|------------------|-----------------------------------|---------------------------|----------------------------|
| SIZE<br><b>B</b> | S&M Part No.:<br><b>SEE TABLE</b> | DWG NO.<br><b>C17340</b>  | REV<br><b>A</b>            |
| SCALE<br>N.T.S.  | Drafter<br><b>B. THOMPSON</b>     | Date:<br><b>3/29/2016</b> | SHEET <b>1</b> OF <b>1</b> |

▲ DENOTES CRITICAL DIMENSION