

PART NUMBER	DESCRIPTION
17214	BOOT 900 µm WHITE
17215	BOOT 900 µm BLACK
17286	BOOT 900 µm AQUA
17287	BOOT 900 µm GREEN
17298	BOOT 900 µm BLUE
18881	BOOT 900 µm BROWN
18882	BOOT 900 µm SLATE
18883	BOOT 900 µm ORANGE
18884	BOOT 900 µm VIOLET
18885	BOOT 900 µm RED
18886	BOOT 900 µm HEATHER VIOLET
18887	BOOT 900 µm YELLOW

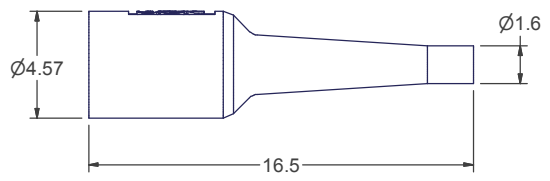
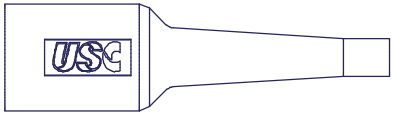

**USCONEC LTD. PROPRIETARY**  
THIS DOCUMENT AND THE ASSOCIATED DATA CONTAIN RESTRICTED INFORMATION THAT IS USCONEC LTD. PROPERTY. DISCLOSE OR DUPLICATE FOR OTHERS ONLY AS AUTHORIZED BY USCONEC LTD.

**Material:**

REV	DATE	DESCRIPTION	ECN
X1	3/4/16	-	1901-bt
A	3/22/16	INITIAL RELEASE	1901-bt
B1	3/15/17	ADD'D P/N's 18881 thru 18887 TO TABLE	2051-mm
B2	3/27/17	CHG'D COLOR NAMES: SLATE w GREY, VIOLET w PURPLE	2051-my
B	4/4/17	RELEASE	2051-mm

**CUSTOMER DRAWING**

DIMENSIONS FOR REFERENCE ONLY

THIRD ANGLE PROJECTION

**METRIC/mm**

▲ DENOTES CRITICAL DIMENSION

Hickory, NC  
800-769-0944  
[www.usconec.com](http://www.usconec.com)

**USCONEC**

TITLE: **BOOT, LC, 900µm**

SIZE	S&M Part No.:	DWG NO.	REV
<b>B</b>	SEE TABLE	<b>C17214</b>	<b>B</b>
SCALE	Drafter	Date:	
N.T.S.	B.THOMPSON	2/25/2016	

SHEET 1 OF 1