

P/N	DESCRIPTION	HOUSING COLOR	FIBER HOLE DIA.
17208	HOUSING ASSEMBLY, LC, 900µm, MM, 126µm + PROTECTIVE CAP	AQUA	0.126 +0.003/-0.000
17209	HOUSING ASSEMBLY, LC, 900µm, SM, 125.5µm + PROTECTIVE CAP	BLUE	0.1255 +0.001/-0.000
17210	HOUSING ASSEMBLY, LC, 900µm, APC, 125.5µm + PROTECTIVE CAP	GREEN	0.1255 +0.001/-0.000
17965	HOUSING ASSEMBLY, LC, 900µm, MM, 126µm + PROTECTIVE CAP	HEATHER VIOLET	0.126 +0.003/-0.000
18877	HOUSING ASSEMBLY, LC, 900µm, MM, 125.5µm + PROTECTIVE CAP	AQUA	0.1255 +0.001/-0.000
18878	HOUSING ASSEMBLY, LC, 900µm, MM, 125.5µm + PROTECTIVE CAP	HEATHER VIOLET	0.1255 +0.001/-0.000
19636	HOUSING ASSEMBLY, LC, 900µm, MM, 126µm + PROTECTIVE CAP	LIME	0.126 +0.003/-0.000
19696	HOUSING ASSEMBLY, LC, 900µm, MM, 125.5µm + PROTECTIVE CAP	LIME	0.1255 +0.001/-0.000

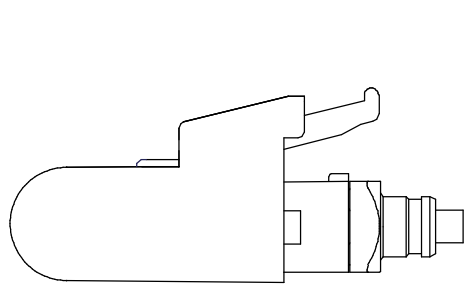

ASSEMBLED VIEW

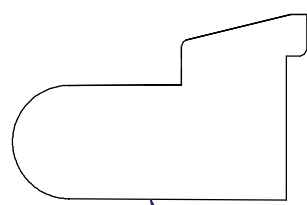
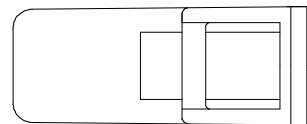

PROTECTIVE CAP

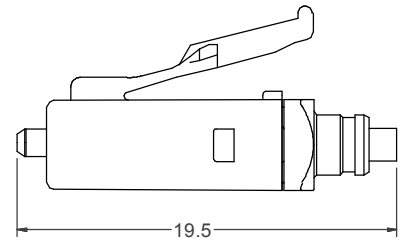
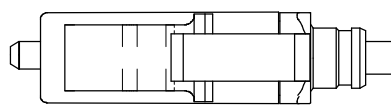

19.5

**USCONEC LTD. PROPRIETARY**  
THIS DOCUMENT AND THE ASSOCIATED DATA CONTAIN RESTRICTED INFORMATION THAT IS USCONEC LTD. PROPERTY. DISCLOSE OR DUPLICATE FOR OTHERS ONLY AS AUTHORIZED BY USCONEC LTD.

**Material:**

REV	DATE	DESCRIPTION	ECN
D1	6/22/17	OMITTED NOTES AND TABLE	2074-mm
D	8/15/17	RELEASE	
E1	11/8/17	REVISED TABLE FORMAT; ADDED ASSEMBLED VIEW	2071-mm
E	12/14/17	RELEASE	
F1	4/18/18	ADDED LIME P/N's 19636 & 19696 TO TABLE	2133-mm
F	5/8/18	RELEASE	

**CUSTOMER DRAWING**

DIMENSIONS FOR REFERENCE ONLY

THIRD ANGLE PROJECTION

**METRIC/mm**

▲ DENOTES CRITICAL DIMENSION

Hickory, NC  
800-769-0944  
[www.usconec.com](http://www.usconec.com)

**USCONEC**

TITLE  
**HOUSING ASSEMBLY, LC,  
900µm**

SIZE	S&M Part No.:	DWG NO.	REV
<b>B</b>	SEE TABLE	<b>C17208</b>	<b>F</b>
SCALE	Drafter	Date:	SHEET
N.T.S.	B.THOMPSON	2/24/2016	1 OF 1