

FULL FLANGE

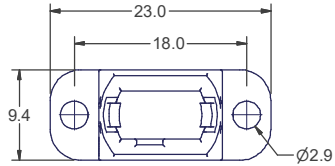

DUST PLUG INSTALLED ON END OPPOSITE SPRING CLIP ON 'ONE DUST PLUG' VERSIONS

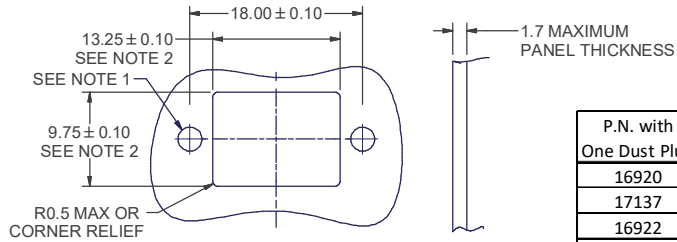
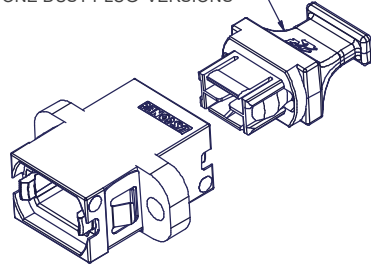

RECOMMENDED MOUNTING CUTOUT

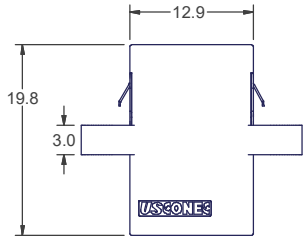

- NOTES:
- RECOMMEND USE OF M2.5 OR 4-40 SCREW, OR SCREW W/ NUT, SCREW HEAD DIAMETER & NUT WIDTH ≤ 5mm. (SCREW & NUT NOT PROVIDED), RECOMMEND 2in-lbf TORQUE FOR SCREW MOUNT APPLICATIONS.
 - ALSO COMPLIANT WITH FOCIS STANDARD TOLERANCE OF ±0.25

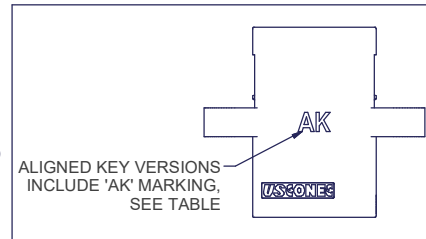

FULL FLANGE

P.N. with One Dust Plug	P.N. with Two Dust Plugs	Color	Key Orientation
16920	16921	Black	Opposed
17137	17138	Aqua	Opposed
16922	16923	Gray	Aligned
17141	17142	Magenta	Opposed
21258	21259	Green	Opposed
21260	21261	Heather Violet	Opposed
21321	21322	Lime	Opposed
21394	21395	Yellow	Opposed
22202	22203	White	Opposed

REDUCED FLANGE

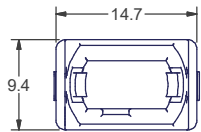

DUST PLUG INSTALLED ON END OPPOSITE SPRING CLIP ON 'ONE DUST PLUG' VERSIONS

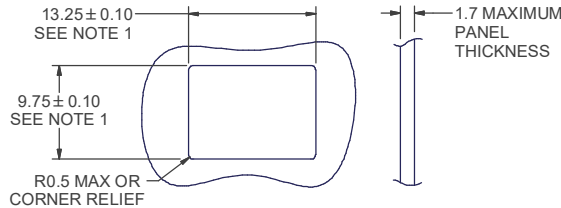
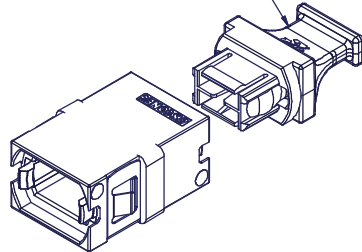

RECOMMENDED MOUNTING CUTOUT

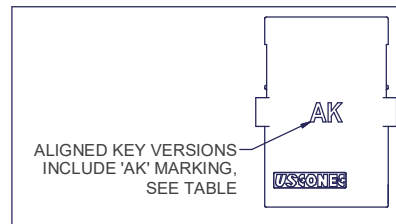
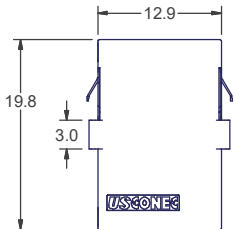

REDUCED FLANGE

P.N. with One Dust Plug	P.N. with Two Dust Plugs	Color	Key Orientation
16926	16927	Black	Opposed
17139	17140	Aqua	Opposed
16928	16929	Gray	Aligned
17143	17144	Magenta	Opposed
21254	21255	Green	Opposed
21256	21257	Heather Violet	Opposed
21318	21320	Lime	Opposed
21392	21393	Yellow	Opposed
22204	22205	White	Opposed

- NOTES:
- ALSO COMPLIANT WITH FOCIS STANDARD TOLERANCE OF ±0.25

PART	MATERIAL
ADAPTER BODY	POLYETHERIMIDE
SPRING CLIP	STAINLESS STEEL
DUST PLUG	POLYCARBONATE

USCONEC LTD. PROPRIETARY
THIS DOCUMENT AND THE ASSOCIATED DATA CONTAIN RESTRICTED INFORMATION THAT IS USCONEC LTD. PROPERTY. DISCLOSE OR DUPLICATE FOR OTHERS ONLY AS AUTHORIZED BY USCONEC LTD.

Material:

REV.	DATE	DESCRIPTION	ECN
B	5/28/19	ADD'D LIME P/Ns TO TABLES; UPDATED ASSY's W/ IMPROVED PLUG	2212-mm
C	7/25/19	ADD'D YELLOW OPTIONS TO TABLES; REVISED TITLE	
D1	1/23/20	ADDED "AK" MARKING TO ALIGNED KEY VERSIONS REVISED RECOMMENDED PANEL THICKNESS NOTE; ROTATED VIEWS (ZONE B6-D6)	2267-mm
D	2/17/20	RELEASE	
E	3/3/20	ADD'D (white) P/N's: 22202, 22203, 22204 & 22205 TO TABLES	

CUSTOMER DRAWING

DIMENSIONS FOR REFERENCE ONLY

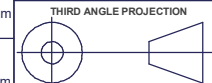

METRIC/mm



Hickory, NC
800-769-0944
www.usconec.com

TITLE
ADAPTER, MTP-16™, SC FOOTPRINT, FF & RF

SIZE A3	S&M Part No.: SEE TABLES	DWG NO. C16920	REV E
SCALE N.T.S.	Drafter M. CLOUD	Date: 7/16/2015	SHEET 1 OF 1

▲ DENOTES CRITICAL DIMENSION