

PART NUMBER	AR COATING WAVELENGTH	PERFORMANCE SPECIFICATION
13950	NONE	< 2.0 dB INTERPOSER
15358	850nm	< 2.0 dB INTERPOSER, ≤ 0.5% REFLECTIVITY
15988	1310nm	< 2.0 dB INTERPOSER, ≤ 0.5% REFLECTIVITY
16261	1550nm	< 2.0 dB INTERPOSER, ≤ 0.5% REFLECTIVITY

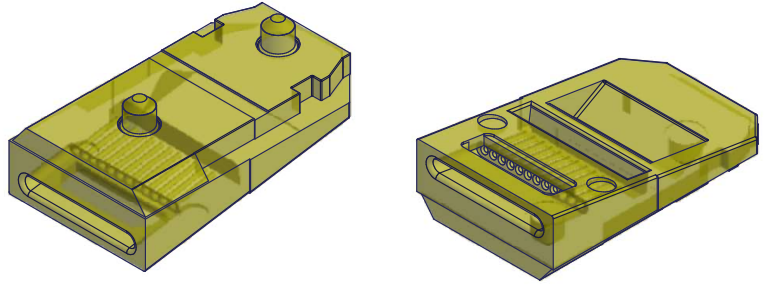

NOTES:
1. COLOR: AMBER, TRANSPARENT

USCONEC LTD. PROPRIETARY
THIS DOCUMENT AND THE ASSOCIATED DATA CONTAIN RESTRICTED INFORMATION THAT IS USCONEC LTD. PROPERTY. DISCLOSE OR DUPLICATE FOR OTHERS ONLY AS AUTHORIZED BY USCONEC LTD.

Material: PEI - MAT'L SPEC #C12605

REV	DATE	DESCRIPTION	ECN
C	8/7/19	RELEASE	1747-mm
D1	3/24/21	ADDED GATE VESTIGE NOTE, MAX 0.2mm	2367-rr
	4/12/21	0.1 MAX GATE VESTIGE WAS 0.2 MAX	
D2	4/28/21	0.125 MAX GATE VESTIGE WAS 0.1 MAX	2367-bh
D	5/4/21	RELEASE	2367-rr

CUSTOMER DRAWING
DIMENSIONS FOR REFERENCE ONLY
THIRD ANGLE PROJECTION

METRIC/mm

▲ DENOTES CRITICAL DIMENSION

USCONEC
Hickory, NC
800-769-0944
www.usconec.com

TITLE FERRULE, 12F, PRIZM® LightTurn®

SIZE B	S&M Part No.: SEE TABLE	DWG NO. C13950	REV D
SCALE N.T.S.	Drafter M. YOUNT	Date: 8/30/2012	SHEET 1 OF 1