

**NOTES:**

1.  $X_i = (2i - n - 1) \times 0.125$ , WHERE  $i$  CORRESPONDS TO THE 'i'th FIBER PER THE NUMBERING CONVENTION, AND  $n$  IS THE TOTAL NUMBER OF FIBERS IN THE ARRAY.
2. MATERIAL: POLYPHENYLENE SULFIDE RESIN, MAT'L SPEC #C7438
3. GUIDE PINS SHOULD HAVE A DIAMETER RANGING FROM 0.697 TO 0.699 TO MINIMIZE INSERTION LOSS.
4. NON-WINDOW SIDE MARKING MAY BE EITHER AS SHOWN ABOVE, OR AS SHOWN HERE...

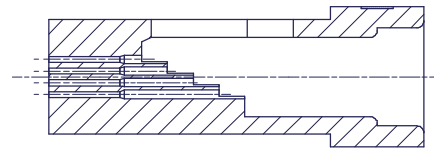

SECTION A-A

**USCONEC LTD. PROPRIETARY**  
THIS DOCUMENT AND THE ASSOCIATED DATA CONTAIN RESTRICTED INFORMATION THAT IS USCONEC LTD. PROPERTY. DISCLOSE OR DUPLICATE FOR OTHERS ONLY AS AUTHORIZED BY USCONEC LTD.

**Material:** SEE NOTES

REV	DATE	DESCRIPTION	ECN
A	10/5/09	INITIAL RELEASE	01104
B1	11/15/16	REVISED MARKING FONT & POSITION; UPDATED DWG & NOTES TO STD. FORMAT; ADDED NOTE 4	1540-my
B	11/29/18	RELEASE	2191-my

**CUSTOMER DRAWING**

▲ DENOTES CRITICAL DIMENSION

Hickory, NC  
800-769-0944  
[www.usconec.com](http://www.usconec.com)

**USCONEC**

TITLE: **FERRULE, 48F, PPS, MM**

DIMENSIONS FOR REFERENCE ONLY

THIRD ANGLE PROJECTION

**METRIC/mm**

SIZE	S&M Part No.:	DWG NO.	REV
B	12405	<b>C12405</b>	B
SCALE	Drafter	Date:	SHEET
N.T.S.	M. YOUNT	2/19/2009	1 OF 1