

Parts List				
ITEM	DESCRIPTION	PART NO.	QTY	NOTES
1	SPRING PUSH, UNIVERSAL, OVAL & RIBBON, MTP®	13822	1	
2	SPRING, UNIVERSAL, 20N	17698	1	
3	PIN CLAMP or PIN SPACER	SEE KIT TABLE COLUMN A	1	NOTE1
4	ASSEMBLY, HOUSING, MTP®	SEE KIT TABLE COLUMN B	1	
5	DUST CAP, MTP®	17242	1	

NOTES:  
 1. MALE CONNECTOR KIT HAS PIN CLAMP ASSEMBLY.  
 FEMALE CONNECTOR KIT HAS FEMALE PIN SPACER.

KIT P/N	KIT DESCRIPTION	PERFORMANCE	COLUMN A	COLUMN B	HSG ASSY COLOR
			PIN CLAMP/SPACER P/N	HSG ASSY P/N	
20044	KIT, MTP®, UNIVERSAL, FEMALE, MM, SHORT, RIBBON, HSF, BEIGE	MM	17795	MTP-A12-11	BEIGE
20045	KIT, MTP®, UNIVERSAL, MALE, MM, SHORT, RIBBON, HSF, BEIGE	MM	17799	MTP-A12-11	BEIGE
20046	KIT, MTP®, UNIVERSAL, FEMALE, MM, SHORT, RIBBON, HSF, BLACK	MM	17795	MTP-A12-02	BLACK
20047	KIT, MTP®, UNIVERSAL, MALE, MM, SHORT, RIBBON, HSF, BLACK	MM	17799	MTP-A12-02	BLACK
20048	KIT, MTP®, UNIVERSAL, FEMALE, MM, SHORT, RIBBON, HSF, AQUA	MM or MM MTP Elite®	17795	7871	AQUA
20049	KIT, MTP®, UNIVERSAL, MALE, MM, SHORT, RIBBON, HSF, AQUA	MM	17799	7871	AQUA
20050	KIT, MTP®, UNIVERSAL, MALE, MM MTP Elite®, SHORT, RIBBON, HSF, AQUA	MM MTP Elite®	17800	7871	AQUA
20051	KIT, MTP®, UNIVERSAL, FEMALE, MM, SHORT, RIBBON, HSF, MAGENTA	MM or MM MTP Elite®	17795	13949	MAGENTA
20052	KIT, MTP®, UNIVERSAL, MALE, MM, SHORT, RIBBON, HSF, MAGENTA	MM	17799	13949	MAGENTA
20053	KIT, MTP®, UNIVERSAL, MALE, MM MTP Elite®, SHORT, RIBBON, HSF, MAGENTA	MM MTP Elite®	17800	13949	MAGENTA
20054	KIT, MTP®, UNIVERSAL, FEMALE, MM, SHORT, RIBBON, HSF, HEATHER VIOLET	MM or MM MTP Elite®	17795	16693	HEATHER VIOLET
20055	KIT, MTP®, UNIVERSAL, MALE, MM, SHORT, RIBBON, HSF, HEATHER VIOLET	MM	17799	16693	HEATHER VIOLET
20056	KIT, MTP®, UNIVERSAL, MALE, MM MTP Elite®, SHORT, RIBBON, HSF, HEATHER VIOLET	MM MTP Elite®	17800	16693	HEATHER VIOLET
20057	KIT, MTP®, UNIVERSAL, FEMALE, MM, SHORT, RIBBON, HSF, MUNSELL VIOLET	MM or MM MTP Elite®	17795	16791	MUNSELL VIOLET
20058	KIT, MTP®, UNIVERSAL, MALE, MM, SHORT, RIBBON, HSF, MUNSELL VIOLET	MM	17799	16791	MUNSELL VIOLET
20059	KIT, MTP®, UNIVERSAL, MALE, MM MTP Elite®, SHORT, RIBBON, HSF, MUNSELL VIOLET	MM MTP Elite®	17800	16791	MUNSELL VIOLET
20060	KIT, MTP®, UNIVERSAL, FEMALE, MM, SHORT, RIBBON, HSF, LIME	MM or MM MTP Elite®	17795	18829	LIME
20061	KIT, MTP®, UNIVERSAL, MALE, MM, SHORT, RIBBON, HSF, LIME	MM	17799	18829	LIME
20062	KIT, MTP®, UNIVERSAL, MALE, MM MTP Elite®, SHORT, RIBBON, HSF, LIME	MM MTP Elite®	17800	18829	LIME
20063	KIT, MTP®, UNIVERSAL, FEMALE, SM, SHORT, RIBBON, HSF, GREEN	SM	17795	16007	GREEN
20064	KIT, MTP®, UNIVERSAL, MALE, SM, SHORT, RIBBON, HSF, GREEN	SM	17800	16007	GREEN
20065	KIT, MTP®, UNIVERSAL, FEMALE, SM MTP Elite®, SHORT, RIBBON, HSF, YELLOW	SM MTP Elite®	17795	16918	YELLOW
20066	KIT, MTP®, UNIVERSAL, MALE, SM MTP Elite®, SHORT, RIBBON, HSF, YELLOW	SM MTP Elite®	17801	16918	YELLOW

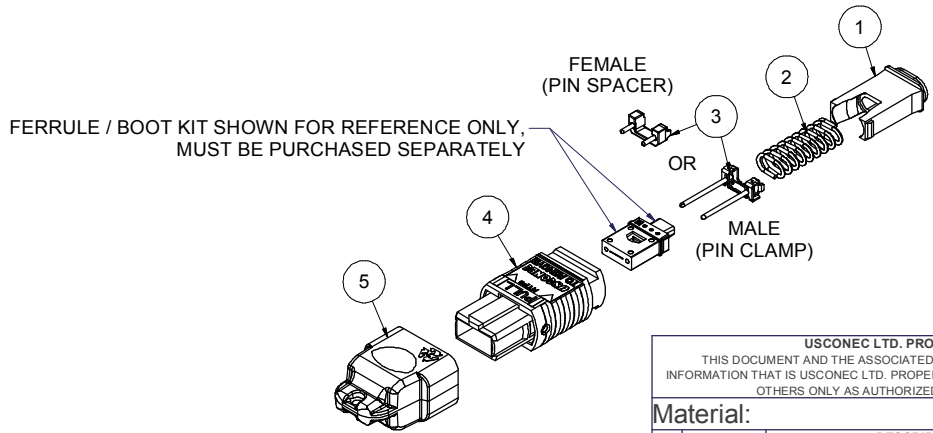

USCONEC LTD. PROPRIETARY  
 THIS DOCUMENT AND THE ASSOCIATED DATA CONTAIN RESTRICTED INFORMATION THAT IS USCONEC LTD. PROPERTY. DISCLOSE OR DUPLICATE FOR OTHERS ONLY AS AUTHORIZED BY USCONEC LTD.

**Material:**

REV	DATE	DESCRIPTION	ECN
X1	4/1/19	---	2206-mm
A	4/16/19	INITIAL RELEASE	

**CUSTOMER DRAWING**

DIMENSIONS FOR REFERENCE ONLY

THIRD ANGLE PROJECTION

**METRIC/mm**

▲ DENOTES CRITICAL DIMENSION

Hickory, NC  
 800-769-0944  
[www.usconec.com](http://www.usconec.com)

**USCONEC**

TITLE  
 KIT, MTP® CONNECTOR, UNIVERSAL, SHORT, RIBBON, HIGH SPRING FORCE

SIZE B S&M Part No.: SEE TABLE DWG NO. **C20044** REV A

SCALE N.T.S. Drafter M.McCROSKEY Date: 4/2/2019 SHEET 1 OF 2

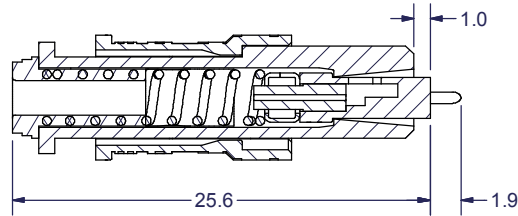
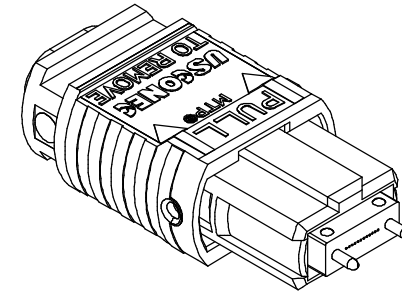
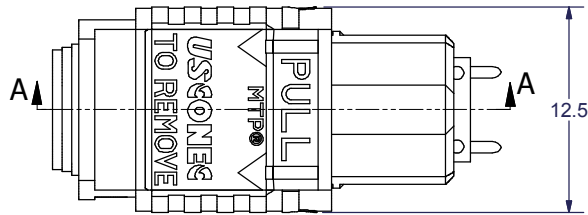
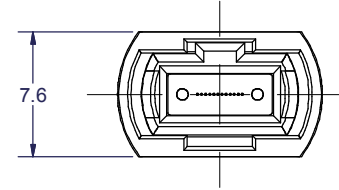
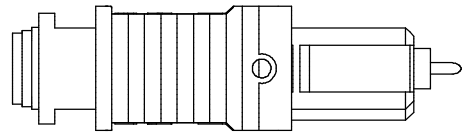

SECTION A-A

▲ DENOTES CRITICAL DIMENSION

USCONEC LTD. PROPRIETARY  
THIS DOCUMENT AND THE ASSOCIATED DATA CONTAIN RESTRICTED INFORMATION THAT IS USCONEC LTD. PROPERTY. DISCLOSE OR DUPLICATE FOR OTHERS ONLY AS AUTHORIZED BY USCONEC LTD.

Material:

REV	DATE	DESCRIPTION	ECN

CUSTOMER DRAWING



Hickory, NC  
800-769-0944  
[www.usconec.com](http://www.usconec.com)

DIMENSIONS FOR REFERENCE ONLY

TITLE  
KIT, MTP® CONNECTOR, UNIVERSAL,  
SHORT, RIBBON, HIGH SPRING FORCE

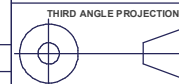

SIZE	S&M Part No.:	DWG NO.	REV
B	SEE TABLE	C20044	A

SCALE	Drafter	Date:	SHEET	OF
N.T.S.	M.McCROSKEY	4/2/2019	2	2