

Parts List				
ITEM	DESCRIPTION	PART NO.	QTY	NOTES
1	SPRING PUSH, UNIVERSAL, OVAL & RIBBON, MTP®	13822	1	
2	SPRING, UNIVERSAL, 9.8N, MTP®	17167	1	
3	PIN CLAMP or PIN SPACER	SEE KIT TABLE COLUMN A	1	NOTE 1
4	ASSEMBLY, HOUSING, MTP®	SEE KIT TABLE COLUMN B	1	
5	DUST CAP, MTP®	17242	1	

NOTES:  
 1. MALE CONNECTOR KIT HAS PIN CLAMP ASSEMBLY.  
 FEMALE CONNECTOR KIT HAS FEMALE PIN SPACER.

KIT P/N	KIT DESCRIPTION	PERFORMANCE	COLUMN A	COLUMN B	
			PIN CLAMP/SPACER P/N	HSG ASSY P/N	HSG ASSY COLOR
20021	KIT, MTP®, UNIVERSAL, FEMALE, MM, SHORT, RIBBON, BEIGE	MM	17795	MTP-A12-11	BEIGE
20022	KIT, MTP®, UNIVERSAL, MALE, MM, SHORT, RIBBON, BEIGE	MM	17799	MTP-A12-11	BEIGE
20023	KIT, MTP®, UNIVERSAL, FEMALE, MM, SHORT, RIBBON, BLACK	MM	17795	MTP-A12-02	BLACK
20024	KIT, MTP®, UNIVERSAL, MALE, MM, SHORT, RIBBON, BLACK	MM	17799	MTP-A12-02	BLACK
20025	KIT, MTP®, UNIVERSAL, FEMALE, MM, SHORT, RIBBON, AQUA	MM or MM MTP Elite®	17795	7871	AQUA
20026	KIT, MTP®, UNIVERSAL, MALE, MM, SHORT, RIBBON, AQUA	MM	17799	7871	AQUA
20027	KIT, MTP®, UNIVERSAL, MALE, MM MTP Elite®, SHORT, RIBBON, AQUA	MM MTP Elite®	17800	7871	AQUA
20028	KIT, MTP®, UNIVERSAL, FEMALE, MM, SHORT, RIBBON, MAGENTA	MM or MM MTP Elite®	17795	13949	MAGENTA
20029	KIT, MTP®, UNIVERSAL, MALE, MM, SHORT, RIBBON, MAGENTA	MM	17799	13949	MAGENTA
20030	KIT, MTP®, UNIVERSAL, MALE, MM MTP Elite®, SHORT, RIBBON, MAGENTA	MM MTP Elite®	17800	13949	MAGENTA
20031	KIT, MTP®, UNIVERSAL, FEMALE, MM, SHORT, RIBBON, HEATHER VIOLET	MM or MM MTP Elite®	17795	16693	HEATHER VIOLET
20032	KIT, MTP®, UNIVERSAL, MALE, MM, SHORT, RIBBON, HEATHER VIOLET	MM	17799	16693	HEATHER VIOLET
20033	KIT, MTP®, UNIVERSAL, MALE, MM MTP Elite®, SHORT, RIBBON, HEATHER VIOLET	MM MTP Elite®	17800	16693	HEATHER VIOLET
20034	KIT, MTP®, UNIVERSAL, FEMALE, MM, SHORT, RIBBON, MUNSELL VIOLET	MM or MM MTP Elite®	17795	16791	MUNSELL VIOLET
20035	KIT, MTP®, UNIVERSAL, MALE, MM, SHORT, RIBBON, MUNSELL VIOLET	MM	17799	16791	MUNSELL VIOLET
20036	KIT, MTP®, UNIVERSAL, MALE, MM MTP Elite®, SHORT, RIBBON, MUNSELL VIOLET	MM MTP Elite®	17800	16791	MUNSELL VIOLET
20037	KIT, MTP®, UNIVERSAL, FEMALE, MM, SHORT, RIBBON, LIME	MM or MM MTP Elite®	17795	18829	LIME
20038	KIT, MTP®, UNIVERSAL, MALE, MM, SHORT, RIBBON, LIME	MM	17799	18829	LIME
20039	KIT, MTP®, UNIVERSAL, MALE, MM MTP Elite®, SHORT, RIBBON, LIME	MM MTP Elite®	17800	18829	LIME
20040	KIT, MTP®, UNIVERSAL, FEMALE, SM, SHORT, RIBBON, GREEN	SM	17795	16007	GREEN
20041	KIT, MTP®, UNIVERSAL, MALE, SM, SHORT, RIBBON, GREEN	SM	17800	16007	GREEN
20042	KIT, MTP®, UNIVERSAL, FEMALE, SM MTP Elite®, SHORT, RIBBON, YELLOW	SM MTP Elite®	17795	16918	YELLOW
20043	KIT, MTP®, UNIVERSAL, MALE, SM MTP Elite®, SHORT, RIBBON, YELLOW	SM MTP Elite®	17801	16918	YELLOW

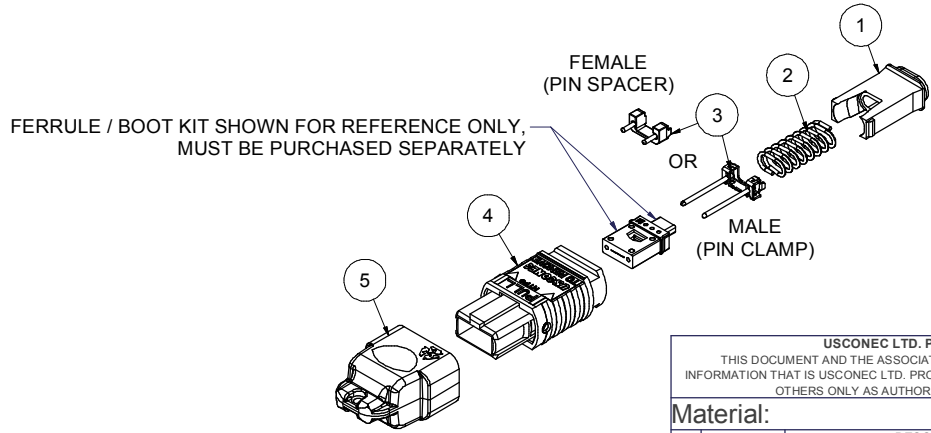

USCONEC LTD. PROPRIETARY  
 THIS DOCUMENT AND THE ASSOCIATED DATA CONTAIN RESTRICTED INFORMATION THAT IS USCONEC LTD. PROPERTY. DISCLOSE OR DUPLICATE FOR OTHERS ONLY AS AUTHORIZED BY USCONEC LTD.

Material:

REV	DATE	DESCRIPTION	ECN
X1	4/1/19	---	2206-mm
A	4/16/19	INITIAL RELEASE	

▲ DENOTES CRITICAL DIMENSION

**CUSTOMER DRAWING**

**USCONEC** Hickory, NC  
800-769-0944  
www.usconec.com

TITLE  
**KIT, MTP® CONNECTOR, UNIVERSAL, SHORT, RIBBON**

DIMENSIONS FOR REFERENCE ONLY

THIRD ANGLE PROJECTION

**METRIC/mm**

SIZE	S&M Part No.:	DWG NO.	REV
<b>B</b>	SEE TABLE	<b>C20021</b>	<b>A</b>
SCALE	Drafter	Date:	SHEET
N.T.S.	M.McCROSKEY	4/2/2019	1 OF 2

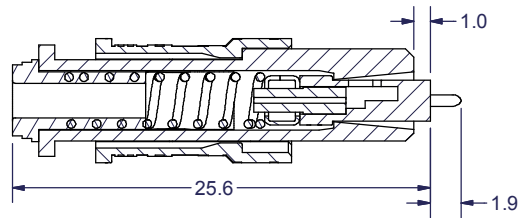
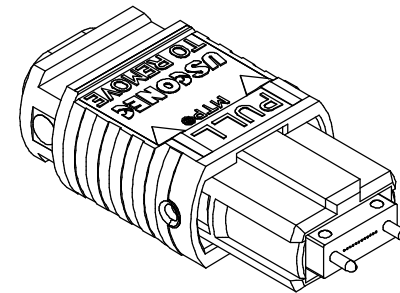
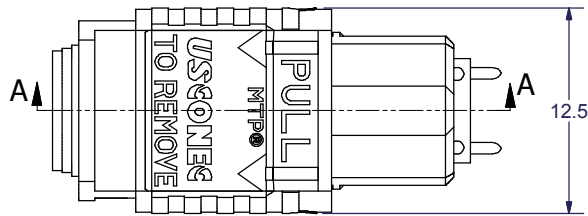
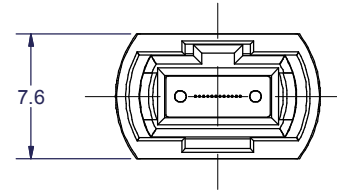
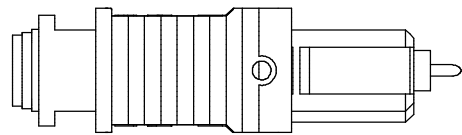

SECTION A-A

USCONEC LTD. PROPRIETARY  
 THIS DOCUMENT AND THE ASSOCIATED DATA CONTAIN RESTRICTED INFORMATION THAT IS USCONEC LTD. PROPERTY. DISCLOSE OR DUPLICATE FOR OTHERS ONLY AS AUTHORIZED BY USCONEC LTD.

Material:

REV	DATE	DESCRIPTION	ECN

**CUSTOMER DRAWING**

DIMENSIONS FOR REFERENCE ONLY

THIRD ANGLE PROJECTION

**METRIC/mm**

**USCONEC** Hickory, NC  
 800-769-0944  
[www.usconec.com](http://www.usconec.com)

TITLE  
**KIT, MTP® CONNECTOR, UNIVERSAL, SHORT, RIBBON**

SIZE <b>B</b>	S&M Part No.: SEE TABLE	DWG NO. <b>C20021</b>	REV <b>A</b>
SCALE N.T.S.	Drafter M. McCROSKEY	Date 4/2/2019	SHEET 2 OF 2

▲ DENOTES CRITICAL DIMENSION