

4					3		2		1		
Parts List					KIT P/N	KIT DESCRIPTION	PERFORMANCE	COLUMN A PIN CLAMP/SPACER P/N	COLUMN B HSG ASSY P/N	COLUMN C SPRING P/N	HSG COLOR
ITEM	DESCRIPTION	PART NUMBER	QTY	NOTES							
1	SPRING PUSH	13822	1		13891	KIT, MTP®, MALE, MM MTP Elite®, SHORT, HFC, HSF, AQUA	MM MTP Elite®	16742	7871	12501	AQUA
2	SPRING	SEE KIT TABLE COLUMN C	1		14194	KIT, MTP®, FEMALE, MM, SHORT, HFC, HSF, BEIGE	MM	12918	MTP-A12-11	12501	BEIGE
					14195	KIT, MTP®, MALE, MM, SHORT, HFC, HSF, BEIGE	MM	16741	MTP-A12-11	12501	BEIGE
					14196	KIT, MTP®, FEMALE, MM, SHORT, HFC, HSF, BLACK	MM	12918	MTP-A12-02	12501	BLACK
3	PIN CLAMP or PIN SPACER	SEE KIT TABLE COLUMN A	1	NOTE 1	14197	KIT, MTP®, MALE, MM, SHORT, HFC, HSF, BLACK	MM	16741	MTP-A12-02	12501	BLACK
					14198	KIT, MTP®, FEMALE, MM, SHORT, HFC, HSF, AQUA	MM or MM MTP Elite®	12918	7871	12501	AQUA
					14199	KIT, MTP®, MALE, MM, SHORT, HFC, HSF, AQUA	MM	16741	7871	12501	AQUA
4	HOUSING ASSY	SEE KIT TABLE COLUMN B	1		17170	KIT, MTP®, FEMALE, MM, SHORT, HFC, HSF, HEATHER VIOLET	MM or MM MTP Elite®	12918	16693	12501	HEATHER VIOLET
					17171	KIT, MTP®, MALE, MM MTP Elite®, SHORT, HFC, HSF, HEATHER VIOLET	MM MTP Elite®	16742	16663	12501	HEATHER VIOLET
5	PROTECTIVE CAP	MTP-012-01	1		18159	KIT, MTP®, FEMALE, SM, SHORT, HFC, HSF, GREEN	SM or SM MTP Elite®	12918	16007	17881	GREEN
					18160	KIT, MTP®, MALE, SM, SHORT, HFC, HSF, GREEN	SM	16742	16007	17881	GREEN
					18161	KIT, MTP®, FEMALE, SM MTP Elite®, SHORT, HFC, HSF, YELLOW	SM MTP Elite®	12918	16918	17881	YELLOW
					18162	KIT, MTP®, MALE, SM MTP Elite®, SHORT, HFC, HSF, YELLOW	SM MTP Elite®	16743	16918	17881	YELLOW

NOTES:

- 1. MALE CONNECTOR KIT HAS PIN CLAMP ASSEMBLY, FEMALE CONNECTOR KIT HAS FEMALE PIN SPACER

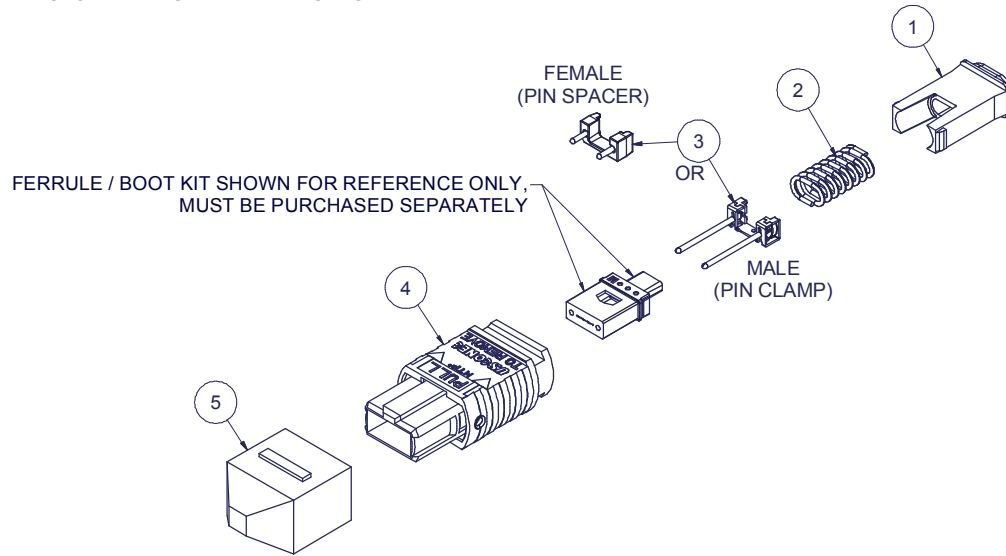

USCONEC LTD. PROPRIETARY
THIS DOCUMENT AND THE ASSOCIATED DATA CONTAIN RESTRICTED INFORMATION THAT IS USCONEC LTD. PROPERTY. DISCLOSE OR DUPLICATE FOR OTHERS ONLY AS AUTHORIZED BY USCONEC LTD.

Material:

REV	DATE	DESCRIPTION	ECN
E1	4/21/16	MALE PIN CLAMP CHG'S: 16741 W 6891 & 16742 W 13376	1914-mm
E	5/5/16	RELEASE	1914-mm
F1	8/4/16	ADD'D KIT P/N's 18159, 18160, 18161 & 18162 TO TABLE; CHG'D SPRING P/N: 17881 was 12501	1967-mm
	11/1/16	ADDED KIT TABLE COLUMN C TO SPECIFY SPRING P/N 12501 OR 17881	
F	12/15/16	RELEASE	

▲ DENOTES CRITICAL DIMENSION

CUSTOMER DRAWING

USCONEC Hickory, NC
800-769-0944
www.usconec.com

TITLE
KIT, MTP® CONNECTOR, SHORT, HFC, HIGH SPRING FORCE

DIMENSIONS FOR REFERENCE ONLY

THIRD ANGLE PROJECTION

SIZE S&M Part No.:
B SEE TABLE
SCALE N.T.S. G. WOLF

DWG NO.
C13890

REV F

Date: 6/23/2011 SHEET 1 OF 2

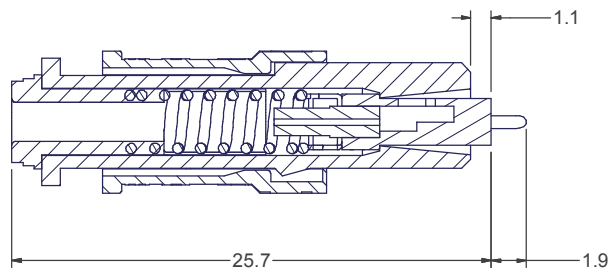
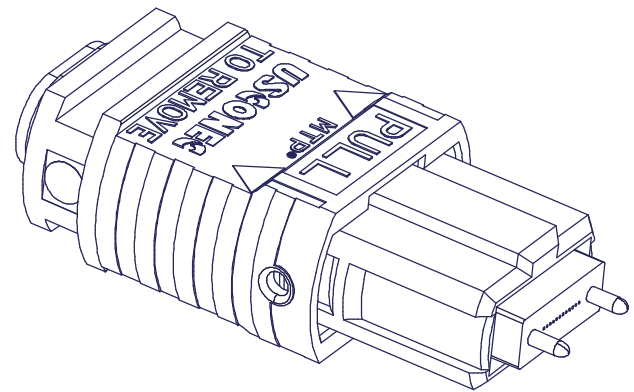
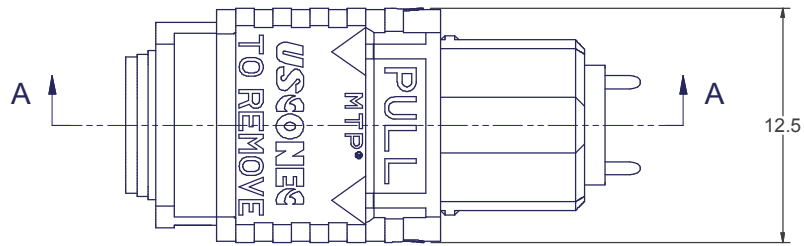
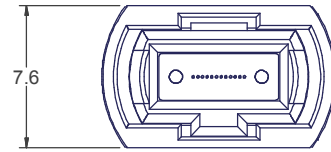
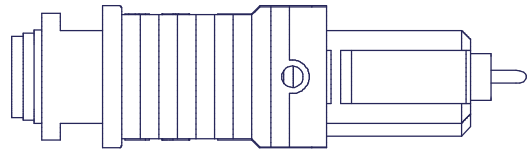

SECTION A-A

USCONEC LTD. PROPRIETARY
THIS DOCUMENT AND THE ASSOCIATED DATA CONTAIN RESTRICTED INFORMATION THAT IS USCONEC LTD. PROPERTY. DISCLOSE OR DUPLICATE FOR OTHERS ONLY AS AUTHORIZED BY USCONEC LTD.

Material:

REV	DATE	DESCRIPTION	ECN
		SEE SHEET 1	

CUSTOMER DRAWING

DIMENSIONS FOR REFERENCE ONLY

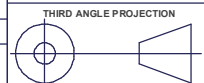

METRIC/mm



Hickory, NC
800-769-0944
www.usconec.com

TITLE
KIT, MTP® CONNECTOR, SHORT, HFC, HIGH SPRING FORCE

SIZE	S&M Part No.:	DWG NO.	REV
B	SEE SHEET 1	C13890	F
SCALE	Drafter	Date:	SHEET
N.T.S.	G. WOLF	6/23/2011	2 OF 2

▲ DENOTES CRITICAL DIMENSION